

MICROFILMED

FILED
GREENVILLE CO. S. C.

JUL 2 4 30 PM '73

DONNIE S. TANKERSLEY
R.M.C.

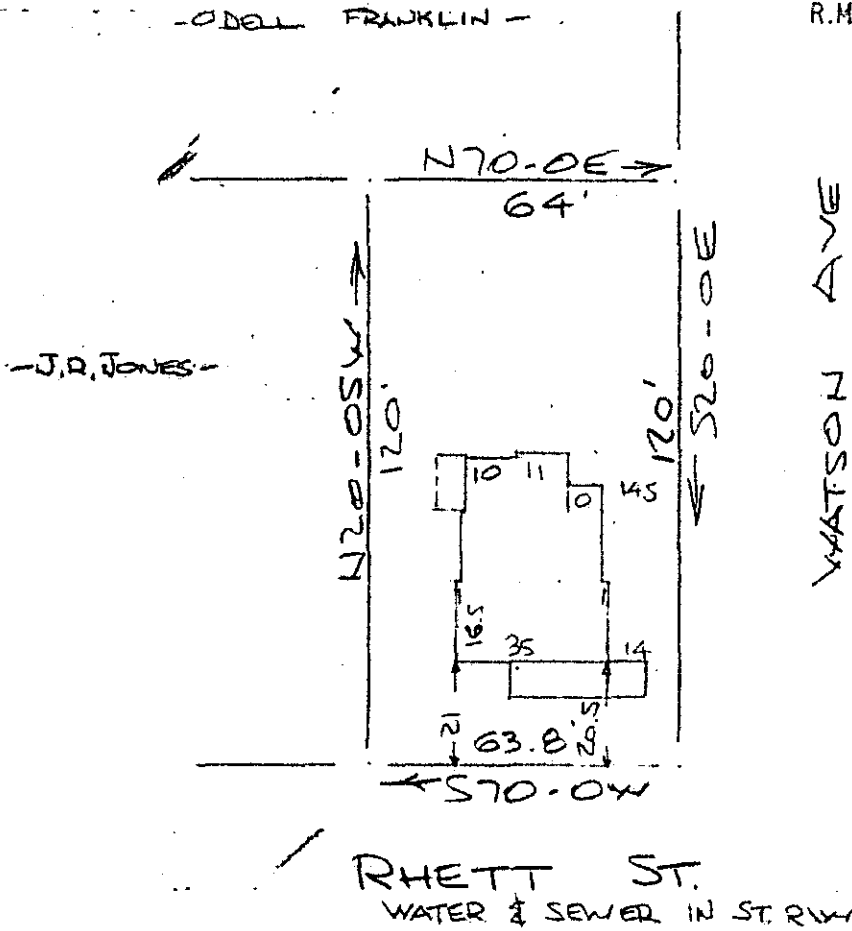

PROPERTY OF
 JAMES HARDY & MARY ALICE F. HARDY
 GREENVILLE, S. C.
 SCALE: 1" = 40' 18 JUNE 1973

This is to certify that on the 18th day of June 1973, I surveyed the property shown on this plat, being known as Property of L. P. HAWKINS and recorded in the RMC Office Greenville County S.C., in Plat Book "D" at Page 28 and also known as PROPERTY OF JAMES HARDY & MARY ALICE F. HARDY and recorded in the RMC Office in Plat Book SA at Page 67 ; and that the property lines, walls, and buildings are as shown hereon, and that the walls and buildings located on said lot do not encroach or project on adjacent street or property, and that no adjacent walls or buildings encroach or project on said premises, and no power lines cross this property except as shown hereon.

R. B. Bruce
 R. B. Bruce, RLS #1952

JUL 2 1973

RECORDING FEE
 PAID \$ 100

CAROLINA ENGINEERING & SURVEYING CO.
 112 Manly St.
 Greenville, S. C.

154

5A+67

130/36