

FILED
GREENVILLE CO. S. C.

RECORDING FEE
PAID \$ 1.72

DEC 15 4 28 PM '72

ELIZABETH RIDDLE
R.M.C.

N 60-42 E -

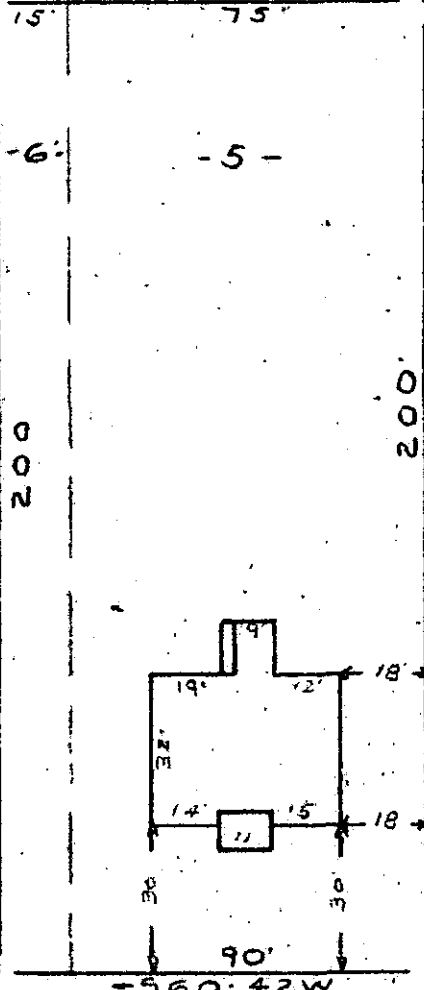

M.A.S.
OLD AUGUSTA ROAD

CRYSTAL AVE
WATER & SEWER IN ST. R/W.

PROPERTY OF
RONNIE G. FARRELL
GREENVILLE S.C.
SCALE 1" = 40' DEC 11, 1972

This is to certify that on the 11th day of December 1972, I surveyed the property shown on this plat, being known as lot 5 & part of lot 6 on plat of PROPERTY OF RONNIE G. FARRELL and recorded in the RMC Office Greenville County, S.C., in Plat Book at Page ; and that the property lines, walls and buildings are as shown hereon, and that the walls and buildings located on said lots do not encroach or project on adjacent street or property, and that no adjacent walls or buildings encroach or project on said premises, and no power lines cross this property except as shown hereon.

R. B. Bruce
R. B. Bruce, RLS #1952

17551
DEC 15 1972
4W-108 ✓

CAROLINA ENGINEERING & SURVEYING CO.
112 Manly Street
Greenville, S. C.