

A. C. Parham

S66-47E 97.8' →

+ 111.5

I.P. 111.6'

I.P. 111.7'

Portion Lot 57

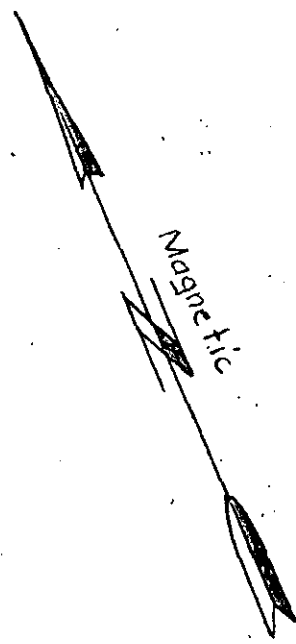

McClure Drive

N18-00E 160'

William & Patricia A. Bass

S24-00W 210'

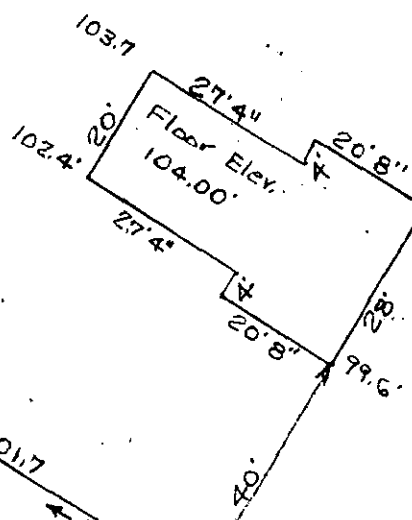

+ 102.9

I.P. 101.7

N34-34W

Toler

B.M. Top of M.H. El. 100.00

+ 100.1

Water Main in Road

San. Sewer

Pole

+ 94.3

FILED
GREENVILLE CO. S. C.
JUL 20 12 42 PM '72
ELIZABETH RIDDLE
R.M.C.

PLOT PLAN

BROWN ENTERPRISES

BATES TWP. GREENVILLE CO. S. C.

RECORDING FEE
PAID \$ 1.00

Scale 1"=30' May 24, 1972

This is to certify that on the 24th day of May 1972, I surveyed the property as shown on this plat; being known as a portion of Lot 57 on plat of "MEADOWBROOK FARMS" recorded in Flat Book "A" at page 105 in the R.M.C. Office of Greenville Co. S.C. and that the property lines & buildings are as shown hereon; and that the buildings located on said lot do not encroach or project onto adjacent roads or property and that no adjacent buildings or walls encroach or project onto said premises; and that the utility lines are as shown.

JUL 20 1972

1827

44/17

T. H. Walker Jr.
T. H. Walker Jr., R.L.S. # 3182
300 Maple Drive
Mauldin, S. C. 29662