

CONTINUED FROM DWG. N2 106-45

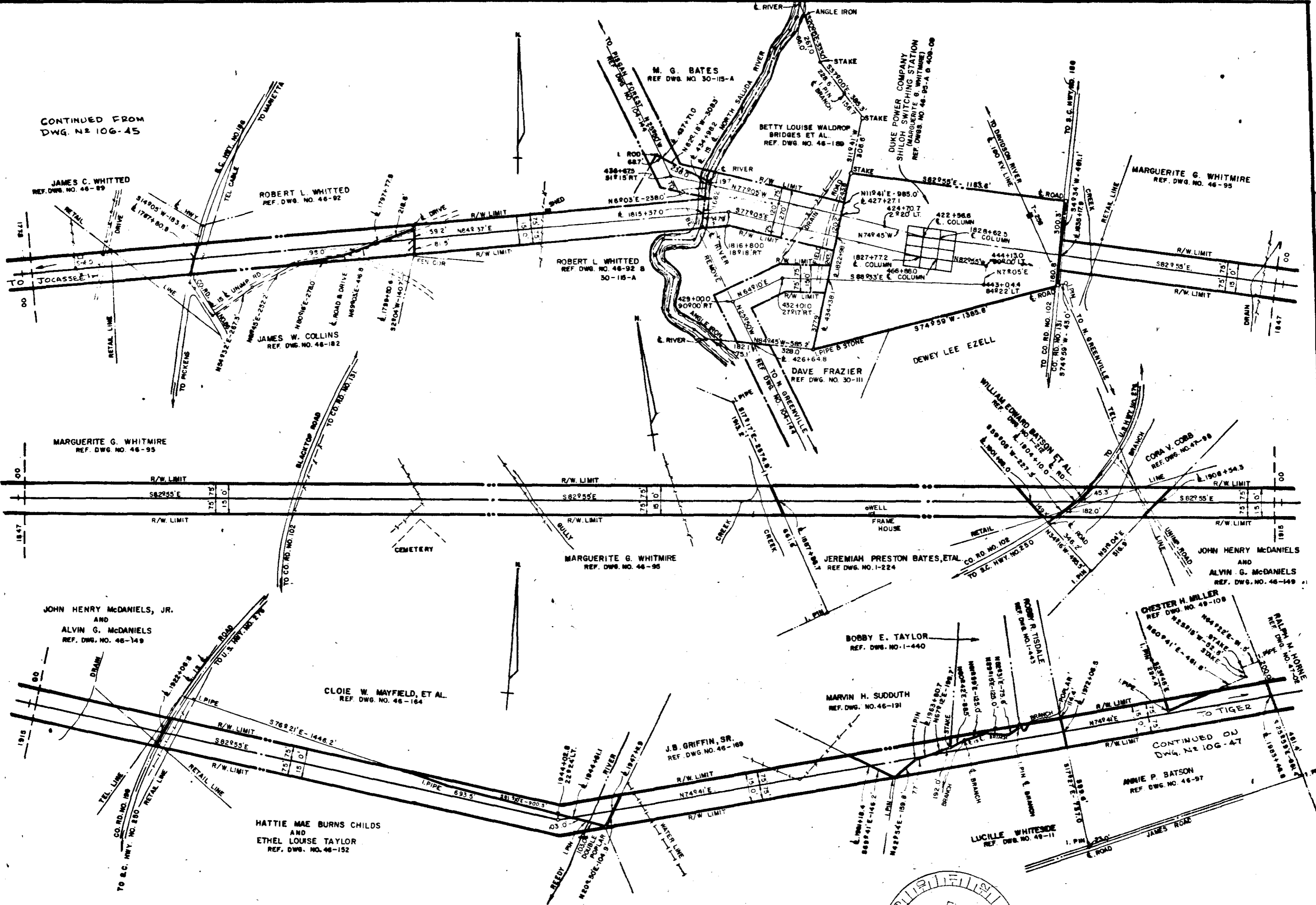

CONTINUED ON DWG. N2 106-47



17324

DEC 13 1972
 45-63 ✓
 DUNE POWER COMPANY
 MAP OF
 RIGHTS OF WAY FOR
 OCONEE-JOCASSEE-TIGER
 TRANSMISSION LINE
 GREENVILLE COUNTY, S.C.

NOTE: DISTANCE ON PROPERTY LINE IS FROM CORNER TO CENTER LINE OF RIGHT OF WAY.

