

For Dedication of Roads see Dedication Book 1 pg 101

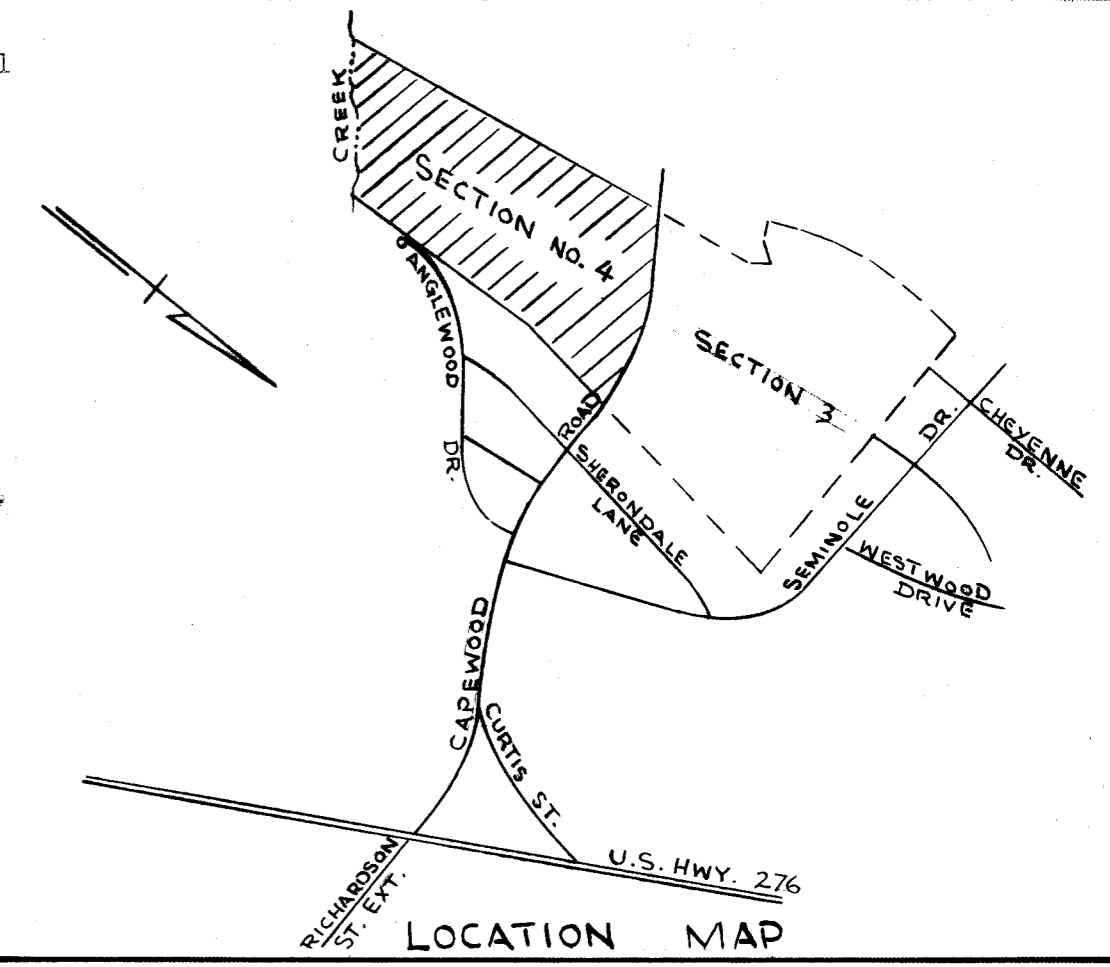

3588 4 Aug 72
4R 30 11:42



NOTES
 5' UTILITY & DRAINAGE EASEMENT ALONG ALL SIDE & REAR LOT LINES UNLESS OTHERWISE SHOWN.
 ALL SAN. SEWER LINES IN STREET R/W
 10' DRAINAGE ESMT.
 10' UTILITY EASEMENT

CERTIFICATE OF OWNERSHIP AND DEDICATION

"The undersigned hereby acknowledge that I am (we are) the owner(s) of the property shown and described hereon and that I (we) hereby adopt this plan of subdivision with my (our) free consent and that I (we) establish the minimum building restriction lines, and hereby dedicate to public use as roads, streets, and easements, forever all areas so shown or indicated on said plat.
 7/26/72 Signed Keith S. Hendrick
 _____ Signed _____
 _____ Signed _____
 _____ Signed _____

CERTIFICATE OF ACCURACY

"I, _____, certify that this plat was (drawn by me) (drawn under my supervision) (an actual survey made under my supervision) from (an actual survey made by me) (deed description recorded in Book 3002, Page 215, Book _____, Page _____, Ord. _____) that the error of closure as calculated by _____ and departures is _____; that the boundaries not surveyed are shown as broken lines plotted from information found in Book _____, Page _____; that this plat was prepared in accordance with the Greenville County Subdivision Regulations as adopted.
 7-25-72 Signed James D. Lamm
 Date _____ Licensed Engineer or Registered Surveyor
 S. C. Registration No. 3320

CERTIFICATE OF APPROVAL FOR RECORDING

"I hereby certify that the subdivision plat shown hereon has been found to comply with the Subdivision Regulations for Greenville County, with the exception of such variances, if any, as are noted in the minutes of the Greenville County Planning Commission of Greenville County, South Carolina, and that it has been approved for recording in the office of the County Register of Deeds.
 Aug 3 1972 Signed J. Thomas Jones
 Chairman, Secretary, or Director of Planning
 Greenville County Planning Commission

4R-30
3588

FINAL PLAT
FILE NUMBER 70-145

SECTION NO. 4
WESTWOOD

PIEDMONT ENGINEERS & ARCHITECTS
 BUILDERS & DEVELOPERS, INC. OWNER
 ZONED R-12 (Simpsonville) SURVEYOR

NO. OF ACRES 34.12 MILES OF NEW ROADS 1.0

NO. OF LOTS 95 DATE 6-7-72

ERROR OF CLOSURE 1/3000+

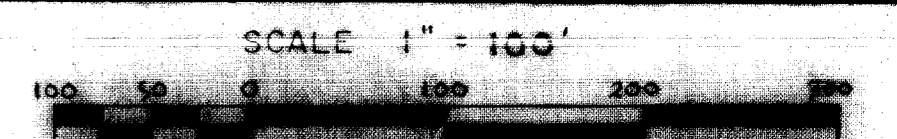

70-145