

MICROFILMED

JOHN MARSHALL COX  
REF DWG. NO. 44-126

CONTINUED FROM DWG. 106-07

CYNTHIA CLARK GAFFNEY  
REF DWG. NO. 44-141

MARGUERITE G. WHITMIRE  
REF DWG. NO. 44-143

J. N. GREENE, ET AL.  
REF DWG. NO. 44-150

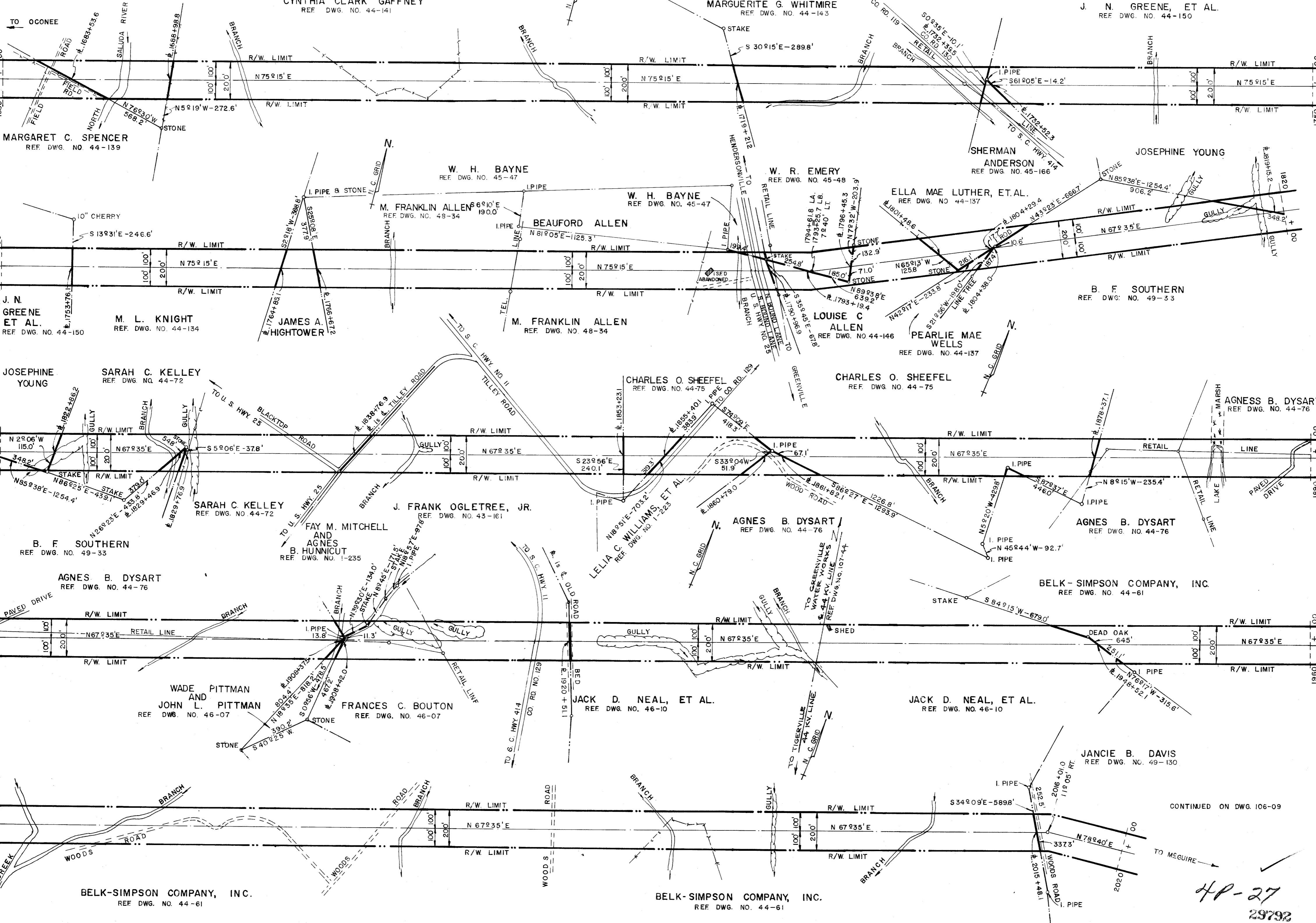

NOTE:  
DISTANCES SHOWN ON PROPERTY LINES  
ARE FROM CORNER TO CENTER LINE  
OF RIGHT OF WAY.

DUKE POWER COMPANY  
MAP OF  
RIGHTS OF WAY FOR  
OCONEE-MCGUIRE  
TRANSMISSION LINE  
GREENVILLE COUNTY, S. C.

SCALE: 1" = 300'  
BOOK NO. 1132, 1136, 1116 & 1120  
300 200 100 0 300 600 900  
JAN. 16, 1970  
FILE NO. 106-08  
SCALE IN FEET

HP-27  
29792

CONTINUED ON DWG. 106-09

TO MCGUIRE