

The location of roads see dedication Book 1 page 87

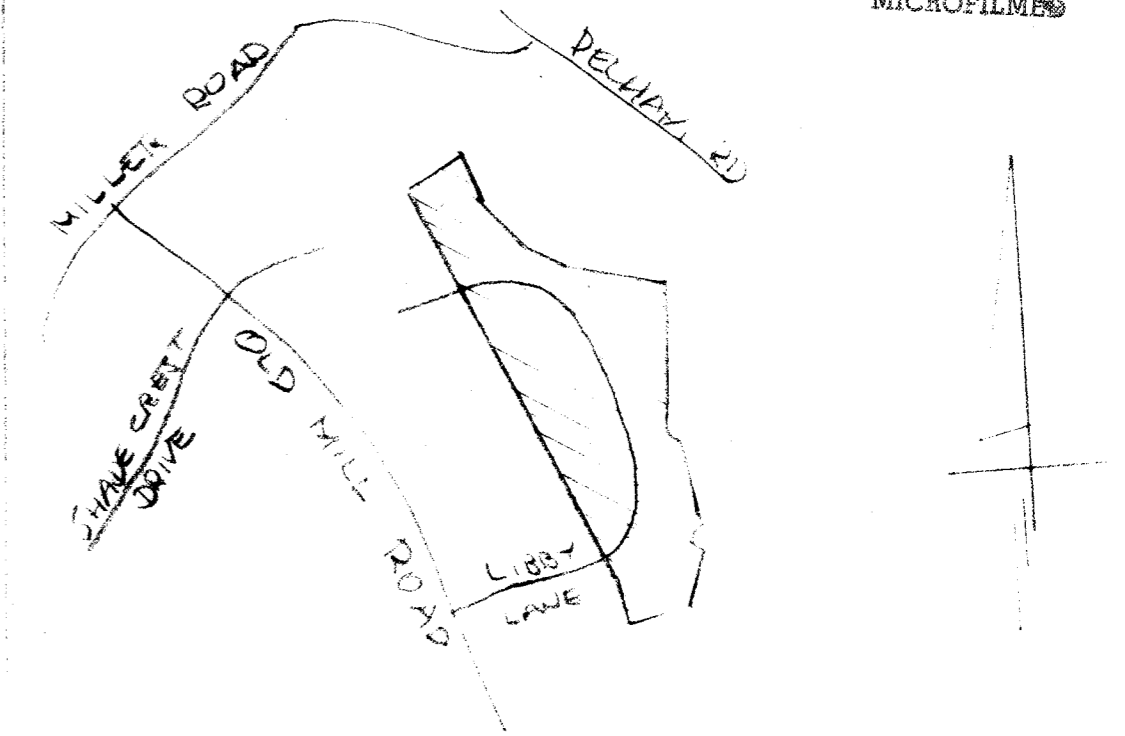

CERTIFICATE OF OWNERSHIP AND DEDICATION

The undersigned hereby acknowledge that I am (we are) the owner(s) of the property shown and described hereon and that I (we) hereby adopt this plan of subdivision with my (our) free consent and that I (we) establish the minimum building setback lines, and hereby dedicate to public use as roads, streets, and easements, forever all areas as shown or indicated on said plat.

..... Signed Eugene Rockley
 Signed Joe E. Hawkins
 Signed _____
 Signed _____

CERTIFICATE OF ACCURACY

I, _____, certify that this plat was (drawn by me) (drawn under my supervision) (an actual survey made under my supervision) from _____ survey made by me (used description recorded in Book _____ Page _____, Book _____, Page _____, etc.) (other); that the error of closure as calculated by _____ and I departures is _____; that the boundaries not surveyed are shown as broken lines plotted from information found in Book _____, Page _____; that this plat was prepared in accordance with the Greenville County Subdivision Regulations as adopted.

..... R. B. Bruce
 Date _____ Licensed Engineer of Registered Surveyor
 S. C. Registration No. 1952

CERTIFICATE OF APPROVAL FOR RECORD

"I hereby certify that the subdivision plat shown hereon has been found to comply with the Subdivision Regulations for Greenville County, with the exception of such variances, if any, as are noted in the minutes of the Greenville County Planning Commission of Greenville County, South Carolina, and that it has been approved for recording in the Office of the County Register of Mense Conveyance."

11/3 1971 J. Clewan Souce
 Chairman, Secretary, or Director of Planning,
 Greenville County Planning Commission

#12805 4 NW 71
 4N 42 11:22 a.

FILE NUMBER 71-139
FINAL PLAT
 SECTION 3
 HILLSBOROUGH

EUGENE E. ROCKLEY
JOE E. HAWKINS
 OWNERS

R. B. BRUCE
 REGISTERED SURVEYOR

19.8 ACRES
35 LOTS
14 JUNE 1971

ERROR OF CLOSURE 1:4100

SCALE: 1"=100'
 100 0 100 200 300 400

INSPECTIONS

EACH PHASE OF CONSTRUCTION IS REQUIRED TO BE INSPECTED AND APPROVED BEFORE ADDITIONAL WORK IS BEGUN.

FOR INSPECTIONS TELEPHONE -

COUNTY ENGINEER
 COURT HOUSE
 242-3910

FILE NUMBER 71-139