

# 20783 Filed This 9 day of March 1971  
 And Recorded in Vol. 42 Page 71 12:31 P.M.  
 Ollie Farnsworth  
 Register Meuse County and Greenville County, S. C.

52

PAINE STREET

S5G-08E 151.4'

REAL ESTATE FUND INC.

42392 Sq. ft  
 0.9731 Acres

FILED  
 GREENVILLE CO. S. C.  
 MAR 9 12 30 PM 1971  
 OLLIE FARNSWORTH  
 R.M.C.

RECTOR ST

JAMES T. & DOROTHY FINLEY

N33-52E 299.8'

X in Concrete

262.5

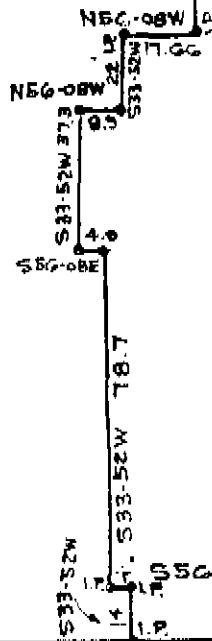

LAURENS ROAD

N56-08W 133.74'

MAR 9 1971

PROPERTY OF 20783

✓ PIEDMONT NURSING HOME Inc.

GREENVILLE S. C.

Scale 1"=50' June 1963

To all parties interested in Title to premises surveyed;  
 This is to certify that on the 14th day of June 1963, I surveyed  
 the property shown on this plat; being the same as shown on plat  
 of Piedmont Nursing Home Inc., Recorded in Plat Book DDD page 63  
 Office of R. M. C. Greenville Co., S. C.; and that the property  
 lines, walls and buildings are as shown hereon; that the  
 buildings located on said lot do not encroach or project on  
 adjacent streets or property; and that no adjacent buildings or  
 walls encroach or project on said premises.

4 I-71

B. W. Dalton

DALTON & NEVES, ENGINEERS.

71