

# Plat Book-4 I-Page 3 A

#17130 Filed This 25 day of Jan 1971  
 And Recorded 4 I Page 3 at 12:42 P.M.  
 Ollie Farnsworth  
 Register of Deeds, Greenville County, S. C.

FILED  
 GREENVILLE CO. S. C.  
 JAN 25 12 42 PM '71  
 OLLIE FARNSWORTH  
 R. H. C.

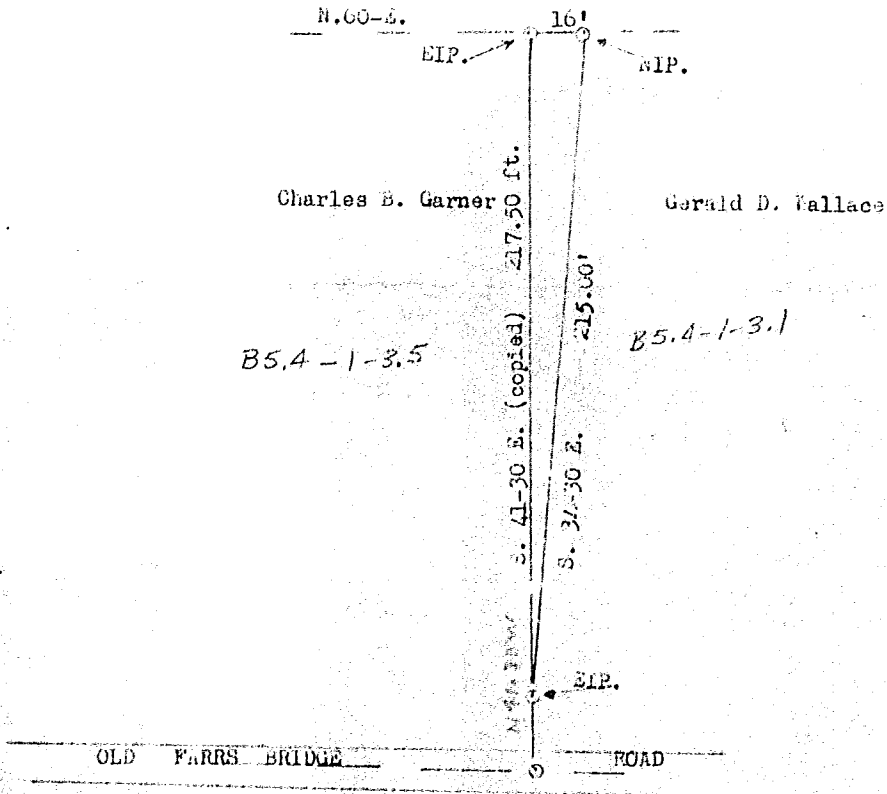

THIS PLAT REPRESENTS A PORTION OF THE GERALD D. WALLACE & EMILY F WALLACE PROPERTY TO BE DEEDED TO CHARLES B. GARNER & GLADYS P. GARNER.

Located in Paris Mountain Township, Greenville County,  
 SOUTH CAROLINA

The plat shown herein is true and correct to the best of my knowledge and belief.

J. D. Prevatt  
 J. D. Prevatt, R. L. S.  
 S. C. 2302

SCALE 1"=50'  
 May 27, 1970  
 Plat drawn 5/27/70  
 BY: AMERICAN SURVEYING & MAPPING CO.

4 I - 3  
 .50¢ ✓

JAN 25 1971

AMERICAN SURVEYING & MAPPING CO.  
 GREENVILLE, S. C.

Book 104 743 Page 535

RECORDING FEE  
 PAID \$ 50¢

17130