

Plat Book 4E, Page 131 B

#2149 Filed This 28 day of July 1970
 And Recorded in Vol. 4E Page 131 at 10:41 A.M.

Ollie Farnsworth
 Register Mesne Conveyance Greenville County, S. C.

**THIS PLAT IS NOT A SUBDIVISION
 AS DEFINED BY THE GREENVILLE
 COUNTY SUBDIVISION REGULATIONS.**

7, 28, 70

J. Johnson
 Chairman, Secretary, or Director of
 Planning.
 Greenville County Planning Commission

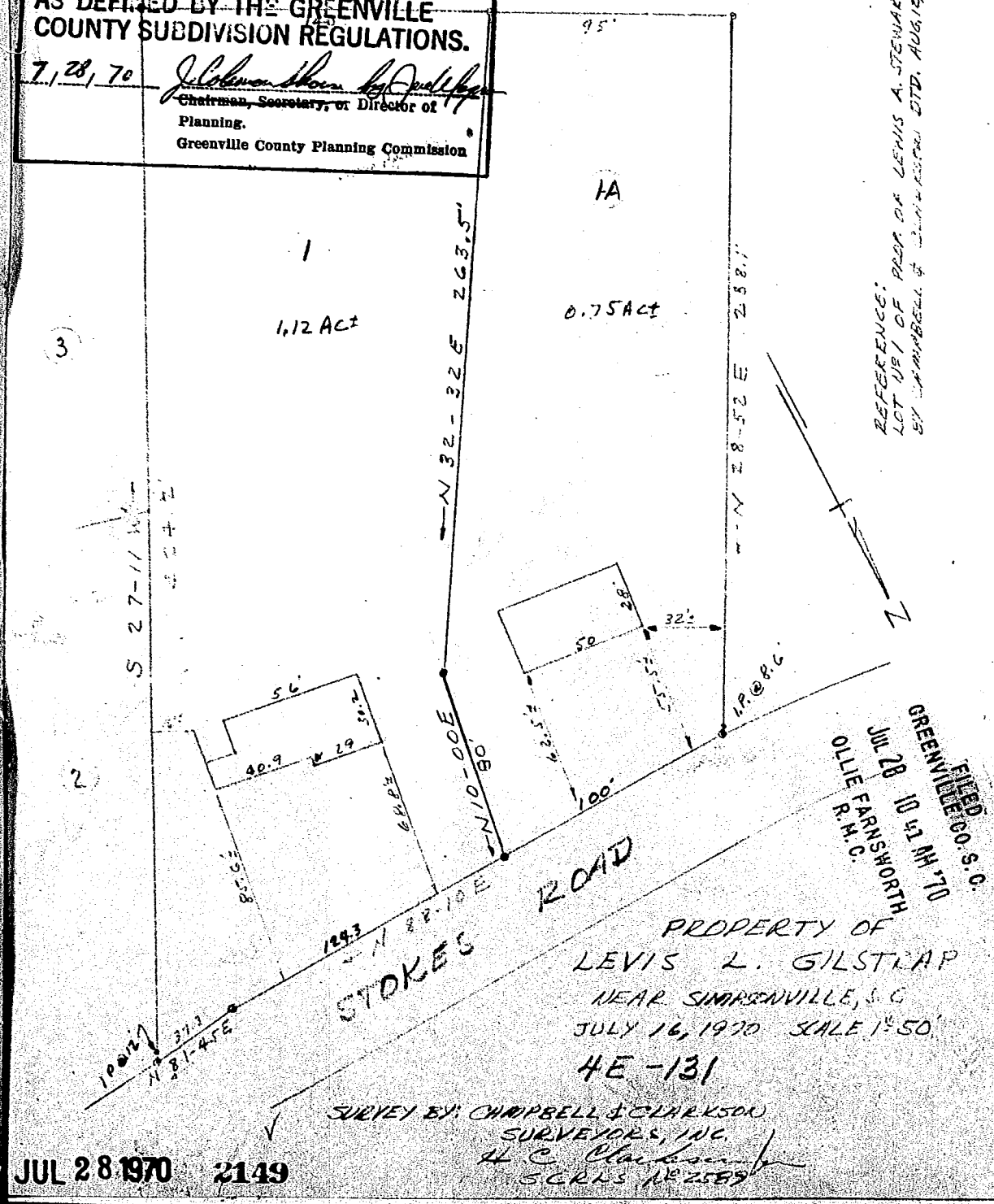

REFERENCE:
 LOT 151 OF PLAT OF LEWIS A. STEWART
 BY CHAPPELL & CLARKSON LTD. AUG. 15, 1966

FILED
 GREENVILLE CO. S. C.
 JUL 28 10 51 AM '70
 OLLIE FARNSWORTH
 R.M.C.

PROPERTY OF
 LEWIS L. GILSTRAP
 NEAR SIMPSONVILLE, S. C.
 JULY 16, 1970 SCALE 1"=50'
 4E-131

SURVEY BY: CHAPPELL & CLARKSON
 SURVEYORS, INC.
H. C. Clarkson
 S.C.R.S. #2559

JUL 28 1970 2149