

#2020 Filed This 24 day of July 1970  
 And Recorded in Vol. 4E Page 129 at 4:57 P.M.  
 Ollie Farnsworth  
 Register Mesne Conveyance Greenville County, S. C.

FILED  
 GREENVILLE CO. S. C.  
 JUL 24 4 57 PM '70  
 OLLIE FARNSWORTH  
 R. M. C.

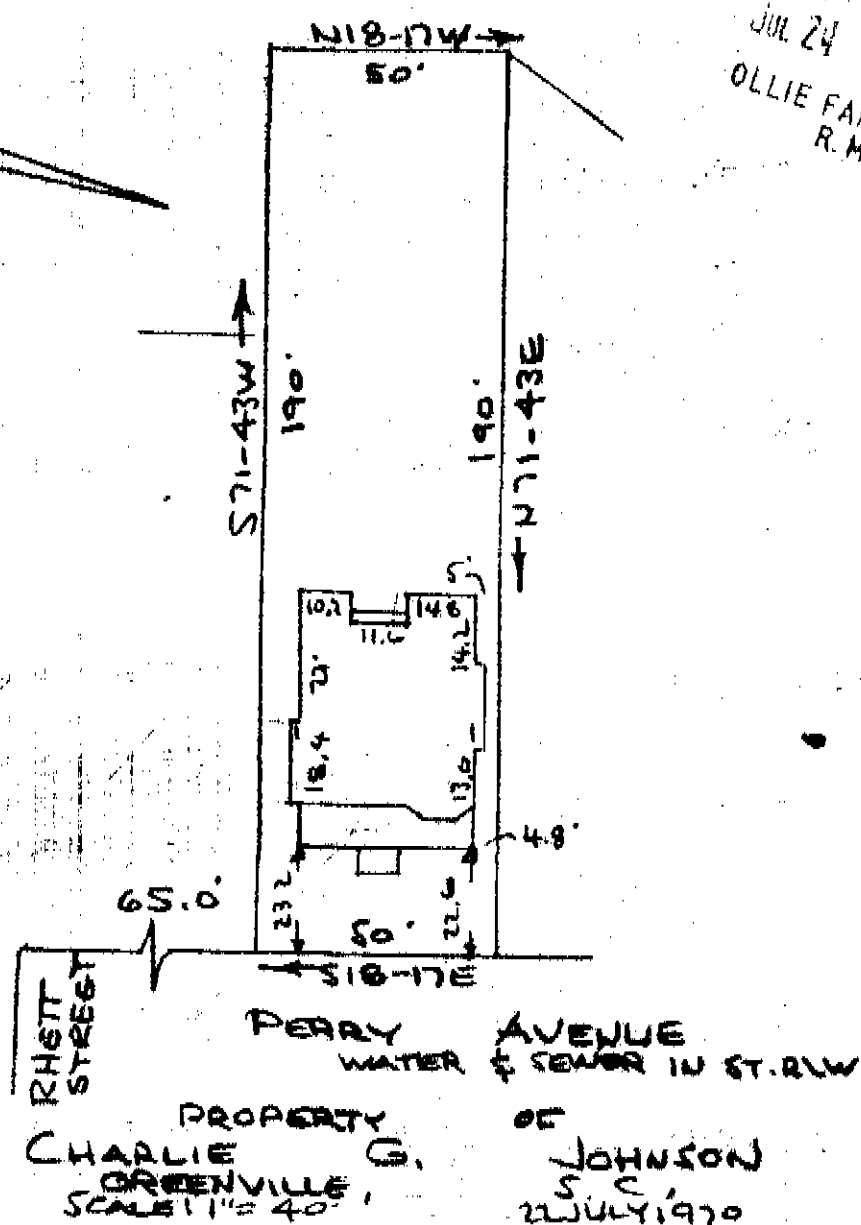
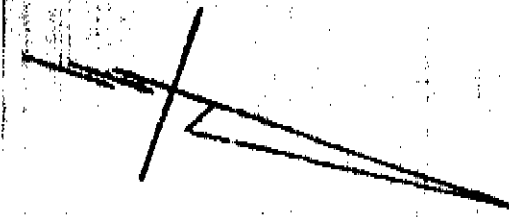

JUL 24 1970

2020

This is to certify that on the 22nd day of July 1970, I surveyed the property shown on this plat, being known as PROPERTY OF CHARLIE G. JOHNSON and recorded in the RMC Office Greenville County, S.C., in Plat Book at Page ; and that the property lines, walls and buildings are as shown hereon, and that the walls and buildings located on said property do not encroach or project on adjacent street or property, and that no adjacent walls or buildings encroach on said premises, and no power lines cross this property except as shown hereon.

4E-129  
 SD#

R. B. Bruce  
 R. B. Bruce, R.L.S. #1952

CAROLINA ENGINEERING & SURVEYING CO.  
 Greenville, South Carolina