

#28376 Filed This 25 day of June 1970

And Recorded in Vol. 4E Page 67 at 2:34 P.M.

Ollie Farnsworth

Register Mesne Conveyance Greenville County, S. C.

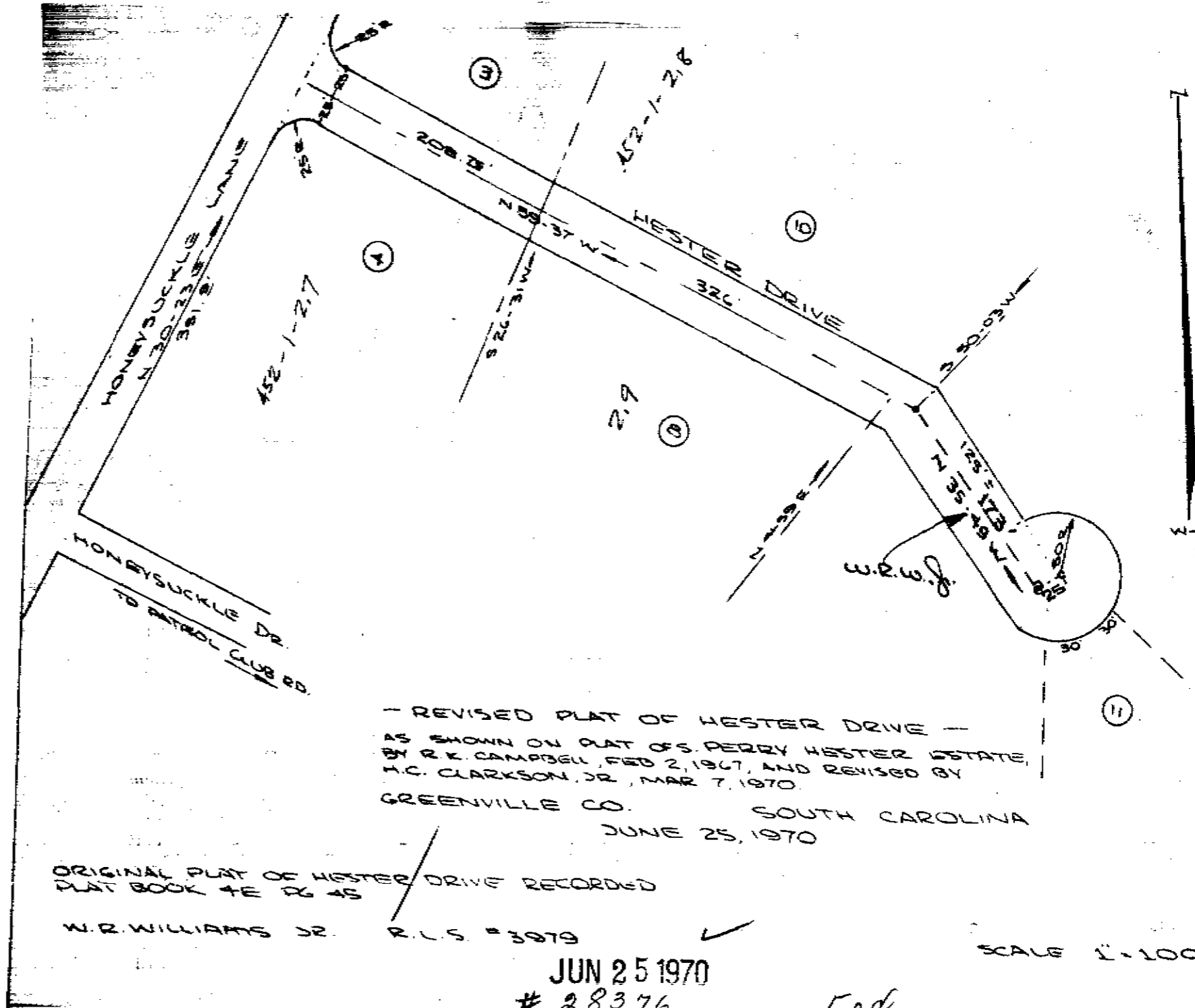

- REVISED PLAT OF HESTER DRIVE -
 AS SHOWN ON PLAT OF S. PERRY HESTER ESTATE,
 BY R. K. CAMPBELL, FEB 2, 1967, AND REVISED BY
 J. C. CLARKSON, JR., MAR 7, 1970.

GREENVILLE CO. SOUTH CAROLINA
 JUNE 25, 1970

ORIGINAL PLAT OF HESTER DRIVE RECORDED
 PLAT BOOK 4E PG 45

W. R. WILLIAMS JR. R.L.S. #3979

JUN 25 1970
 # 28376

SCALE 1" = 100'

50¢

4E-67

GREENVILLE, S. C.
 JUN 25 2 34 PM '70
 OLLIE FARNSWORTH
 R.M.S.