

Laid down by a scale of 12  
Twenty chain to an inch

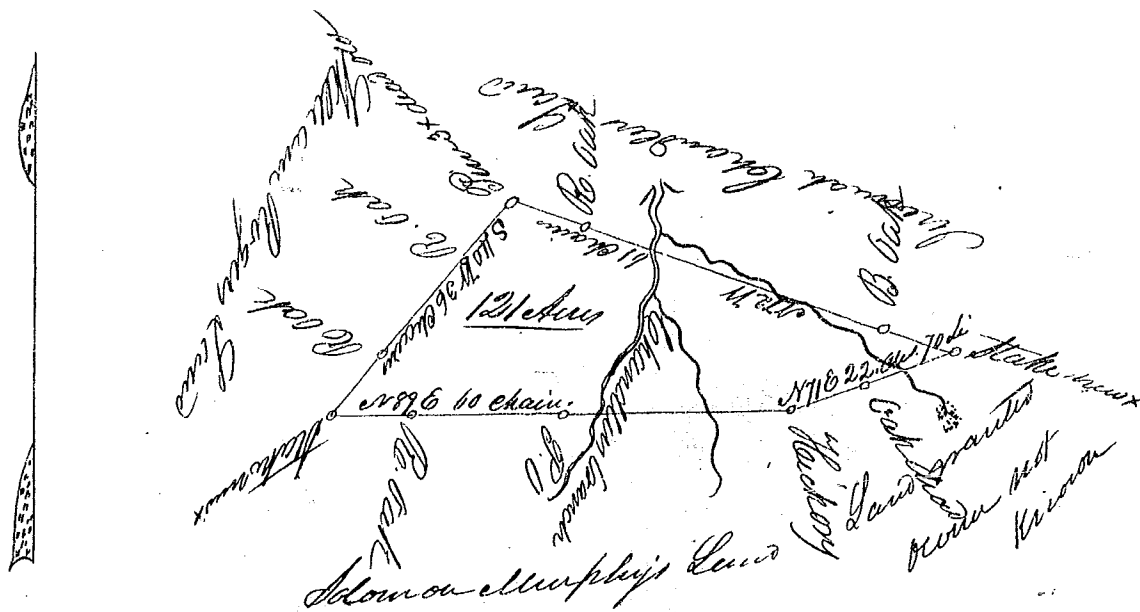

State of South Carolina

Pursuant to a warrant from  
John Watson Esq. Compt. of Locations in the district of  
Greenville and State aforesaid dated the 29<sup>th</sup> of April 1839  
I have administered and laid out unto said John Watson Esq.  
a tract of land containing one hundred and twenty one  
acres situated in the said district on both sides of a  
branch commonly called Chandler's branch which  
runs into Boushy Creek water of Peedy river bounded  
by a line remaining N. W. by land surveyed for Jeremiah  
Chandler, and S. W. by land surveyed for William Rogers  
and N. E. by land surveyed for Solomon Murphy and  
N. E. by land surveyed for persons unknown and both  
such form and marks as the above plat represents.  
Surveyed the 30<sup>th</sup> day of April 1839

Willis D. Threlkeld  
Deputy Surveyor

Recorded the 1<sup>st</sup> day of May 1839

Per John Watson C. S. G. O.