

(197)

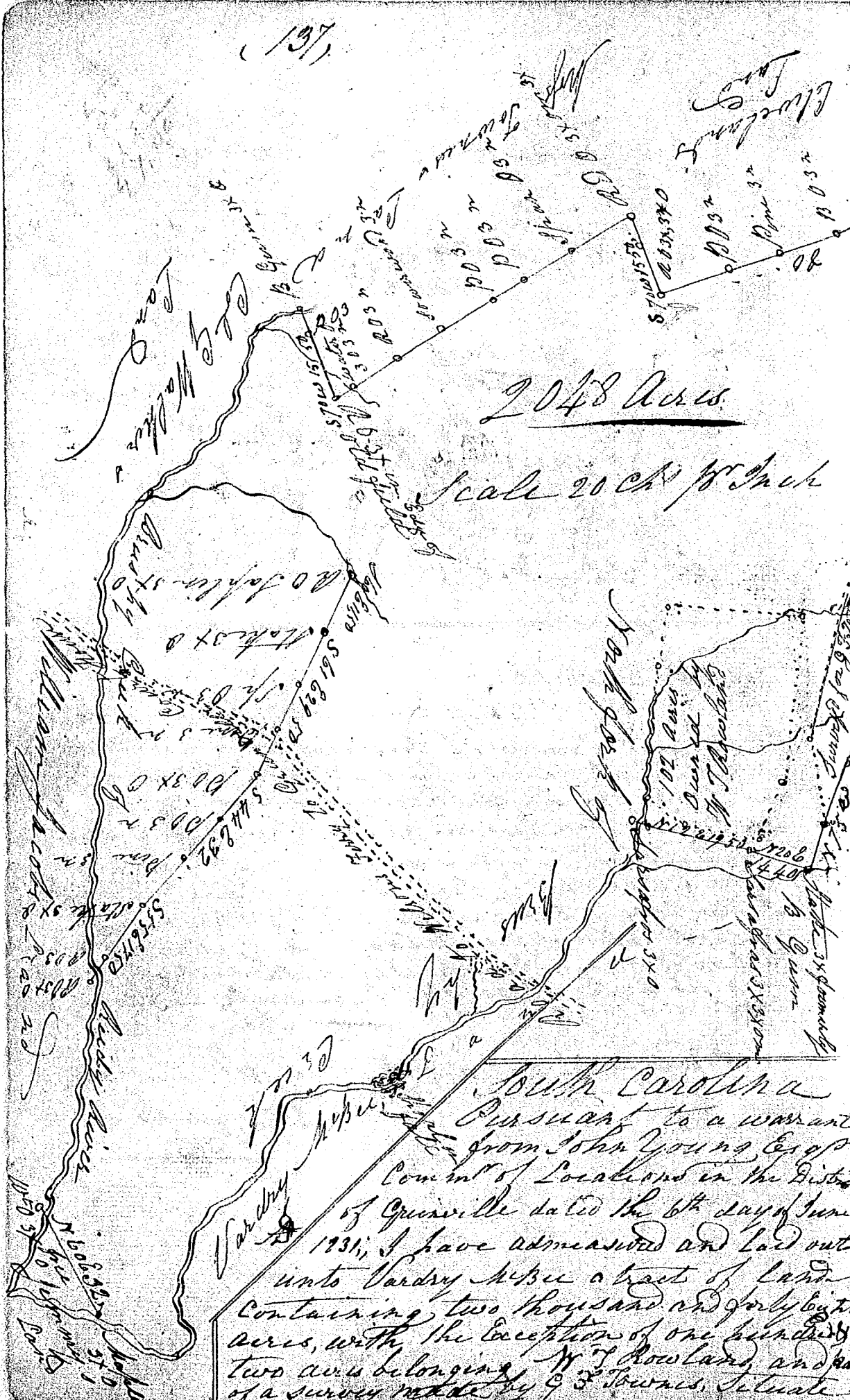

2048 Acres

Scale 20 ch per inch

South Carolina  
 Pursuant to a warrant  
 from John Young Esq  
 Comr of Locations in the District  
 of Greenville dated the 6th day of June  
 1931, I have admeasured and laid out  
 unto Vardry Mabee a tract of Land  
 containing two thousand and forty eight  
 acres, with the exception of one hundred  
 two acres belonging to W. J. Rowland, and  
 of a survey made by G. S. Townes, Situate