

Laid down at 204
Chas 18th Dec

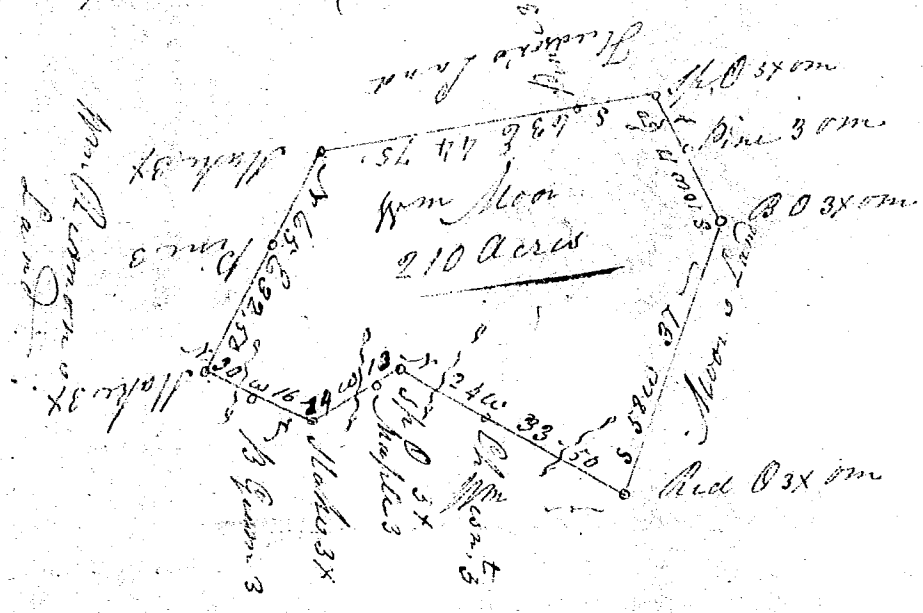

South Carolina

Pursuant to a warrant from John Young, Commr of Locations for the District of Greenville bearing date the 10th day of August 1821. I have caused to be admeasured and laid out unto William Moor a tract of 210 Acres of Land on ^{small} Branches of Brush Creek waters of Enore River — Bounded by Waddell's lines SW, by Hudson's lines SE, by Redmond's lines NE and NW, the other sides by the said William Moor's lines, and has such form and marks as the above Plat Represents. Surveyed and Certified by me this 16th day of August 1821.

B Griffith D^r

Recorded the 25th day of Sept^r 1821 by John Young C^l