

(22)

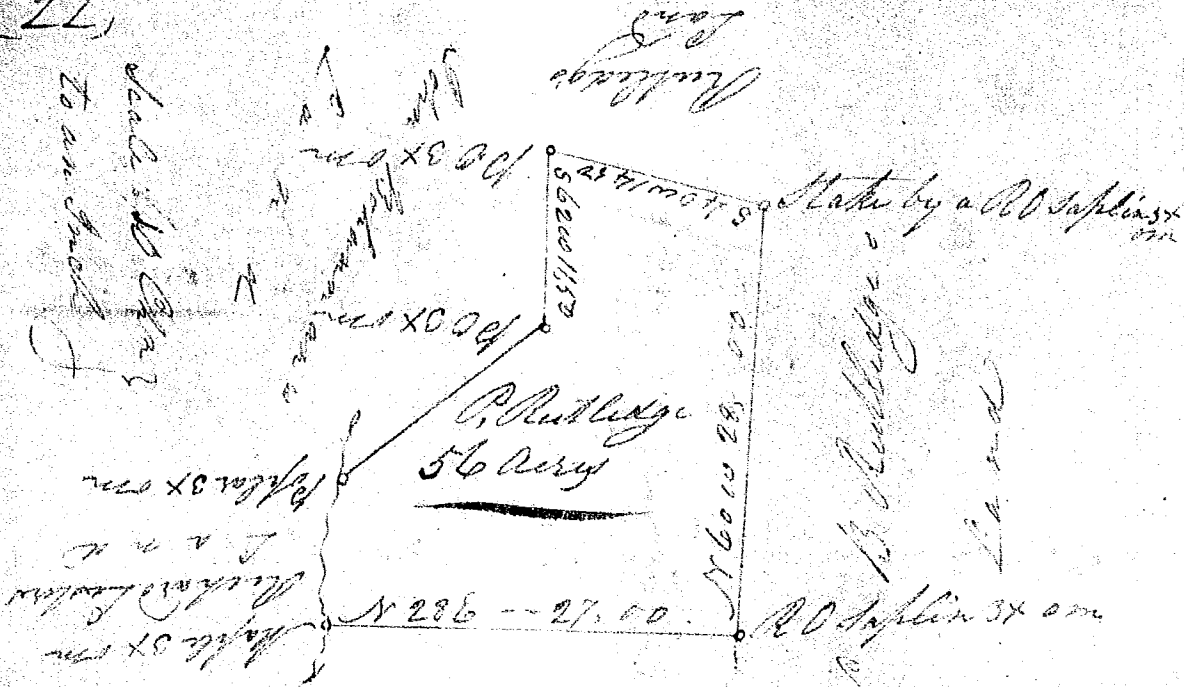

Burrell Perrot's Land  
 State of Carolina

Pursuant to a warrant from John Young Commissioner of Locations dated the 24<sup>th</sup> day of April 1820, I have admeasured and laid out unto Pascal Rutledge a tract of fifty-six acres of Land situate lying and being in Greenville District, on the E<sup>o</sup> side of a small branch of the Ruddy fork of Ruddy River. Bound ed S<sup>o</sup> wardly on Burrell Perrot's land to the N<sup>o</sup> on P<sup>o</sup> Rutledge's to the W<sup>o</sup> on Rutledge's, to the S<sup>o</sup> and S<sup>o</sup> W<sup>o</sup> by John Bohannan and Richard P... Lands. And hath such shape, form, and marks as the above Plat represents.

Surveyed the 25<sup>th</sup> day of April 1820

John Young De<sup>d</sup>

Recorded the 29<sup>th</sup> of April 1820

John Young C<sup>l</sup>