

Scale 20 Chas for Inch (14)

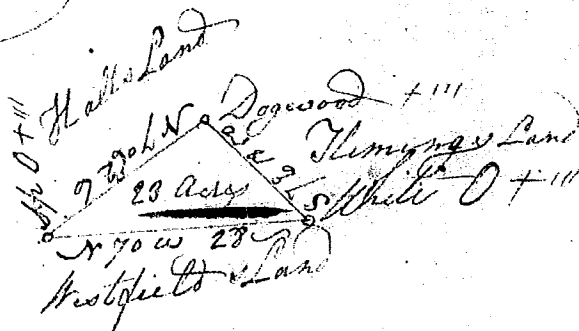

So Carolina I hereby certify that I have
 Greenville District & admeasured ^{land} ~~land~~ out unto
 Humphrey Hall a tract or parcel of Land, having such
 shape & form as the above Plat represents, Bounded
 on the S^o by Land of Halls, on the N^o by Land
 of John Westfield, on the East by Land of White Fleming
 Laid out the 5th of Oct^r 1819 by

Recorded the 4th day of Nov^r 1819, by
 J. Turner D

John Young CL

handed to self