

Scale 20 Ch^r for Survey 1847

Wm Hawkins } Ch^r
Jos Christopher } Survey

2037

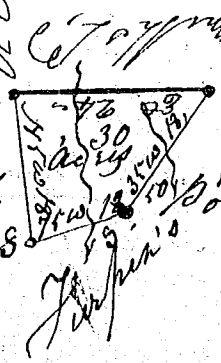

State in Smith's Survey
P. A. 037

Wm Hawkins
of survey
to Joseph

Post Office

North Carolina
 Greenville District } Pursuant to a warrant
 from John Young Esq. Comm^r of Locations
 dated the 23rd day of March 1818, I have admea-
 sured and laid out unto Jos^r Christopher a tract
 of thirty acres of Land, situate lying and
 being in Greenville District, on both sides of
 the branches of Enore River, bounded to the N
 & W on Land granted to Wm Surpin, to the S on
 Smith's Land and to the E on Land granted to
 Young Griffen, and hath such shape form
 and marks as the above Plat represents,

Surveyed the 28th day of March 1818,

John Young D. S.

Recorded the 3rd day of April 1818 by

John Young C. Locat.