

South Carolina (76)

Pursuant to a warrant from Mr. D. Thomas Com. Loc. in the district of Greenville, dated the 14th day of February 1809

I have admeasured & laid out unto Abner Senter, a tract of land containing 162 acres

Situate in said District on a branch of Morgans creek

Bounded by lands wt. & N. of Rachel Erxion, S. by Patson & S.E. by Gowens, & N.E. by Senter's Land, and hath such form & marks as the above plat represents

Survey, & this 14th day of March 1809
Recorded this 2nd Sept. 1813 Del. Self James Whitten D.

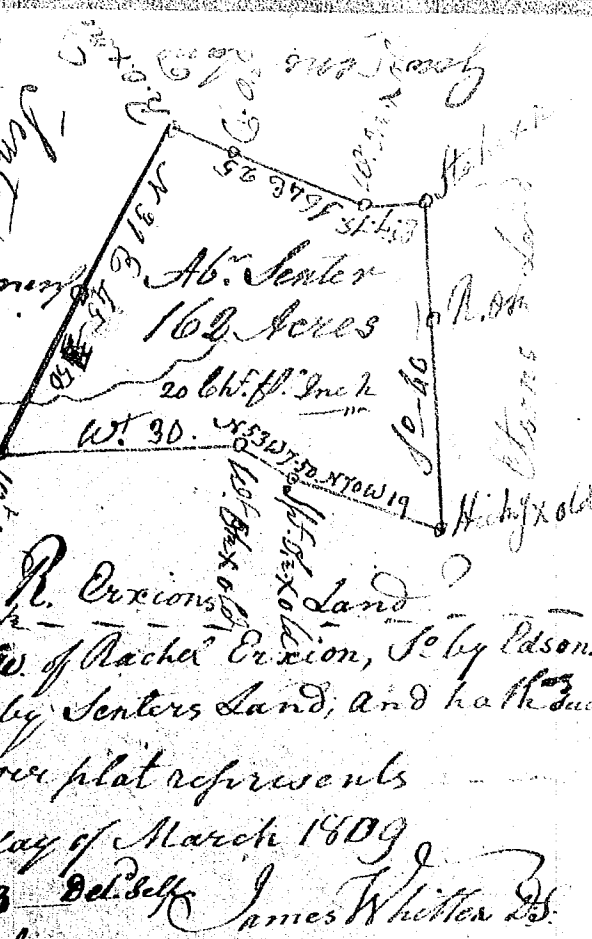

So Carolina

Pursuant to a warrant from Mr. D. Thomas Comm. Locations, in the district of Greenville dated the 14th day of May 1813, I have admeasured & laid out unto John Gilliland a plantation of

tract of land containing one hundred acres. Situate in the said District, on both sides of Oil Camp creek, waters of the Middle fork of Saluda River; Bounded by a line running N E by Aaron Stalton's land S W & S E by David Gilliland's land & all other sides by vacant land, & hath such shape & marks as the above plat represents. Survey the 15th May 1813

Recorded the 11th Oct 1813

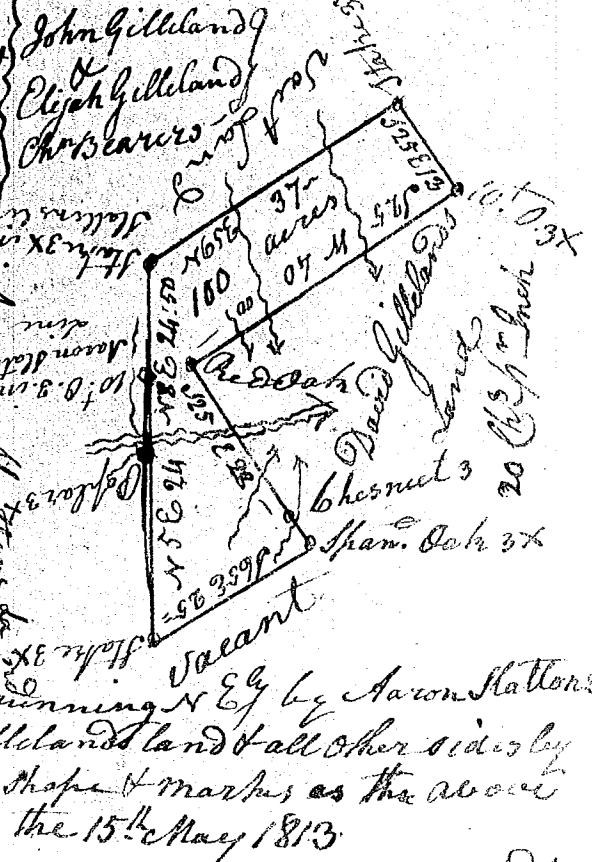

Wm. H. Coshe D.