

State of S^c Carolina = page (71) continued

Pursuant to a
warrant from
Com. D. Thomas,
Com. Locations, for
Greenville District
dated the 25th March
1812 - I have admeas.
& laid out unto
Samuel Williams

Robert Maxwell's land

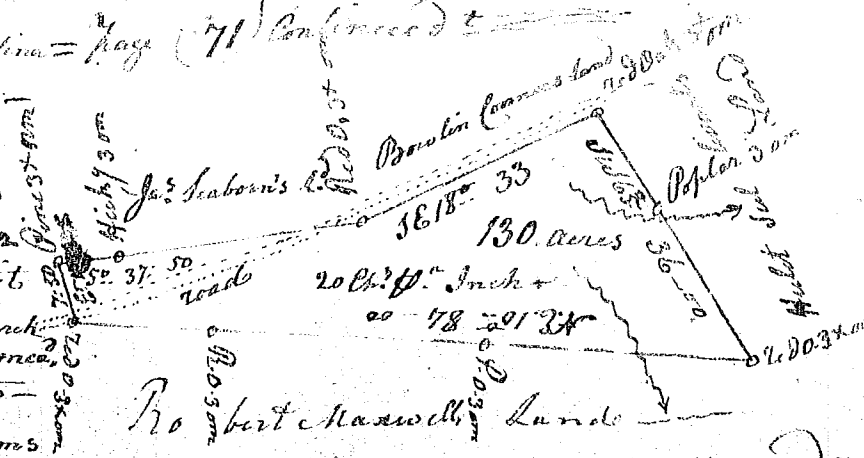

and Micajah Berry, a tract of land containing one hundred & thirty seven Situate in said district, on branches of the Rocky fork of the Golden Grove creek waters of Saluda River - Bounded by a line running N & E by land survey for Robert Maxwell, S & E by land survey for James Seaborn, S & E by land survey for Bowling Green & S W by land survey for Hulet Sullivan. That such form & marks as the above plat represents.

Survey'd the 26th March 1812 by Micajah Berry D^{ist}
Recorded the 1st day of April 1812 deliv^d Map - Berry

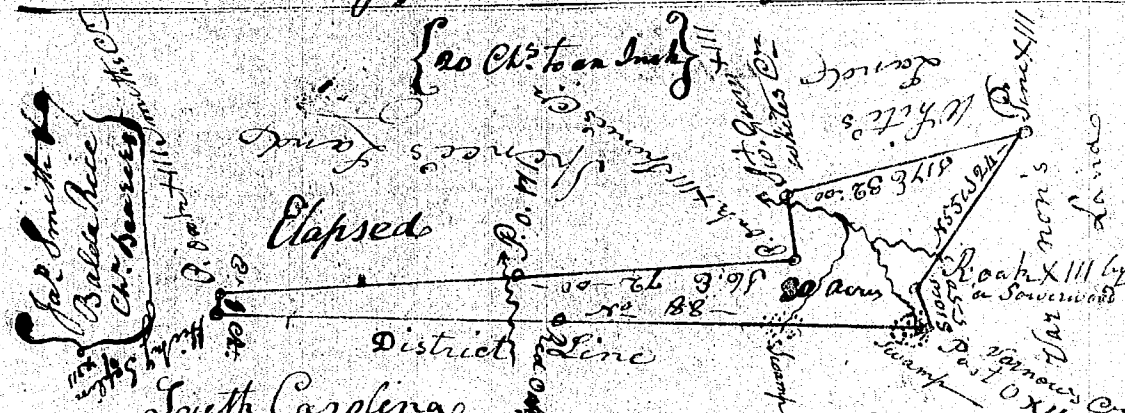

South Carolina
Pursuant to a warrant from Com. D. Thomas Com. Locⁿ
in the district of Greenville dated the 6th Aug^t 1811 - I have
admeasured & laid out unto John Spence a tract of land
containing Eighty acres, Situate in said district on the waters
of the South hole fork of Tygar river, & Bounded on the East by
the district line, on the S & W by land laid out for Jas
Darnon & on the N & E by land laid out to J. Clayton & W^h
That such shape form & marks as the above plat represents.

Survey - 10th August 1811 by J. Whitten D^{ist}
Recorded the 16th day of May 1812 (and Elapsed by
& for Samuel Spence)