

South Carolina

(64)

Pursuant to a warrant from Wm. Thomas Esq, for the district of Greenville, dated the 8th day of Novem^r. 1810 I have admeasured & laid out unto James W. Cooke - a tract of land containing Twenty four acres. Situate in said district, on a branch of Lynch's creek Waters of the N^e fork of Saluda river Bounded by a line running N E by John Lynch's land, NW, by Elijah Gorman's land & W by Cooke & Spriggs's land & E by Wm. Cox's land - and hath such form & marks as the above plat represents - Survey'd the 9th Nov^r. 1810 - Recorded 21st Nov^r. 1810 -

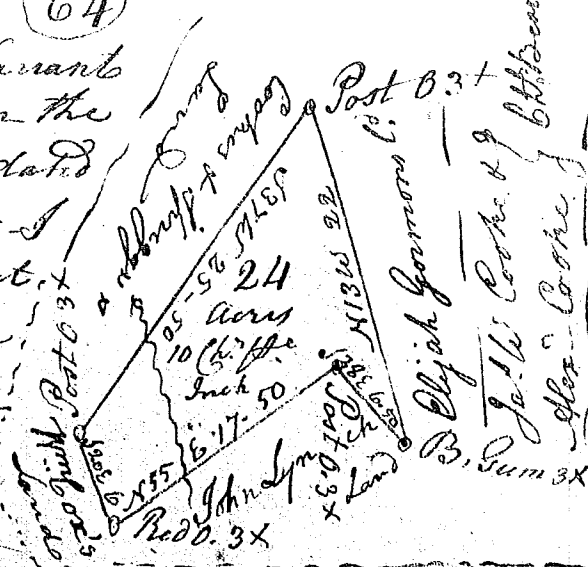

Wm. Cooke Esq

State of S^c Carolina

Pursuant to a warrant from Wm. Thomas Esq for Greenville dist. dated the 9th of Oct^r. 1810 I have admeasured & laid out unto Hockaty Brister a tract of fifty three acres of land. Situate on Greenville District, on a branch of the waters of Saluda river Bounding on N E by Alex. Acker's land on the N E by Thompson Brister's land & S W by Charles Estes land & have such form & marks as the above plat represents -

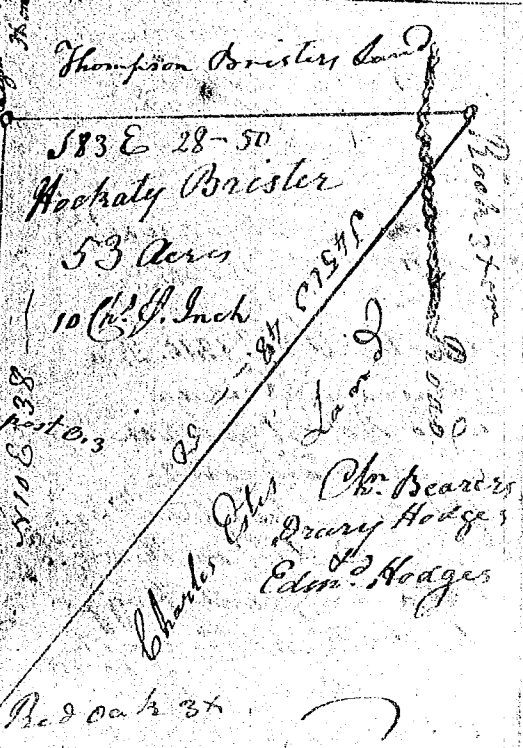

Survey'd the 19th day of Oct^r. 1810
 Given under my hand
 Micajah Barry D.
 Recorded this 15th Decem^r. 1810