

State of S. Carolina
Pursuant to
a warrant from
Wm. J. Thomas
Com. Gen. for the
District of Greenock
with date the
8th day of Aug. 1807

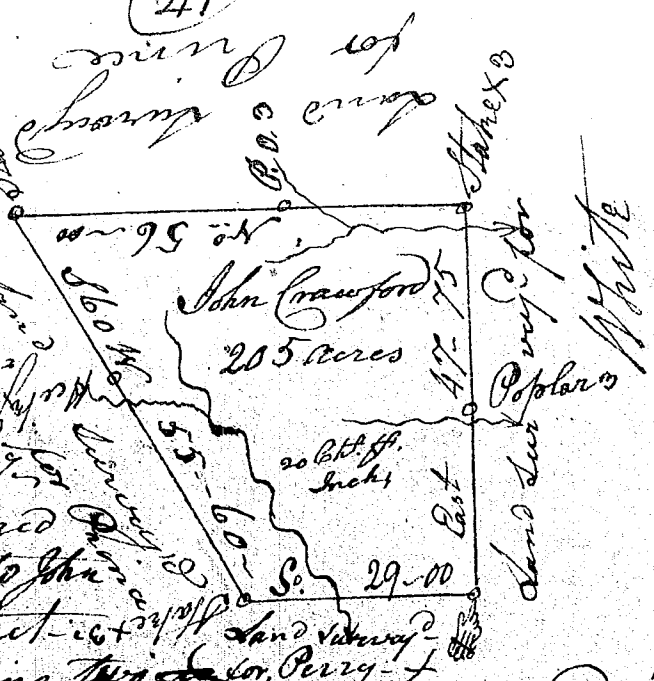

I have admeasured
& laid out unto John
Crawford a tract
of land containing two
hundred & five acres, situate in said District
On Mill-shoal creek, Waters of Enoree River, bounded
by lands surveyed for White on the Se. by lands surveyed
for Prince on the E. & by land surveyed for
Perry on the W. And hath such form & marks
as the above plat represents

Surveyed the 4th Oct. 1807
Recorded the 16th October 1807
Wm. Anderson D.S.