

S. Carolina } Pursuant to (25)
 Greenville District } warrant from Wm. Thom
 to me directed dated January 19th

1805 I have ~~measured~~ measured ~~and~~ laid out unto Benjamin

Pollard junr, a tract of land
 containing seventy six acres
 in Greenville District on a branch
 of Beedy River, having such
 shape, marks, boundings & buttings
 as are represented by the above
 plat surveyed the 21st Jan'y 1805

Recorded 25th Feb'y 1805 J. H. Harrison D.S.

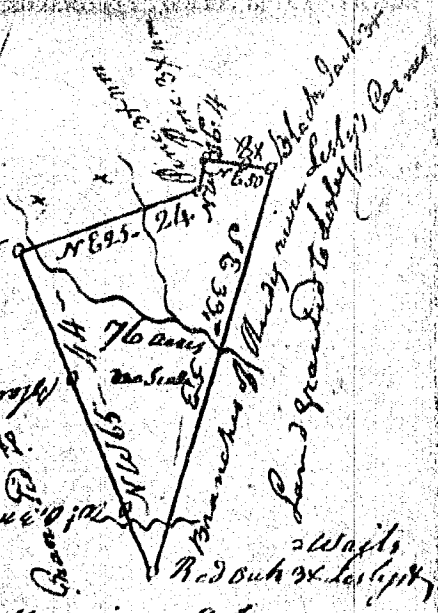

S. Carolina
 Pursuant to
 warrant from

Wm. D. Thomas Esq. 666
 in Greenville District
 dated the 21st Decr 1804

I have admeasured & laid out unto John
 Watson, a tract of Fifty
 four acres & an half situated
 in said district, on Frohock
 Creek, Waters of South Tygar
 River. By a line running
 S E by land Surveyd for John Watson
 & Wm. D. Thomas. N W by land Surveyd
 for John Thomas junr. & hath such
 form & marks as the above represents

Surveyd the 21st Decr 1804

Recorded this 20th March 1805 Dan. McVane D.S.

