

Page 1 of 2

Thomas Com. Linn
Greeneville District
Date the 28th Jan 1804

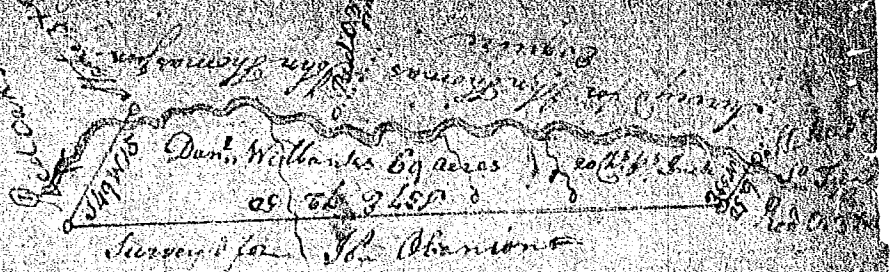

and a tract unto Daniel Wilbanks a tract of sixty nine acres of
 land situated in State & District aforesaid, Bounding by lines to
 the S. E. by land Originally surveyed for Daniel Obanion John Thomas
 & by land Originally surveyed for Joseph Obanion 149
 acres & Originally surveyed for David Moore on the South by the
 banks of the Sugar River & hath such shape, form, marks, &
 boundaries as the above plot represents, Dated the 28th Jan 1804
 Done the 30th Jan 1804 Del. self. J. P. Kellogg

Carolina

Proceedant to a
 warrant from William
 Thomas Esq. Lord
 at the 1st Feb 1804
 are a measure of
 tract unto David
 with a tract of four
 eight acres of land

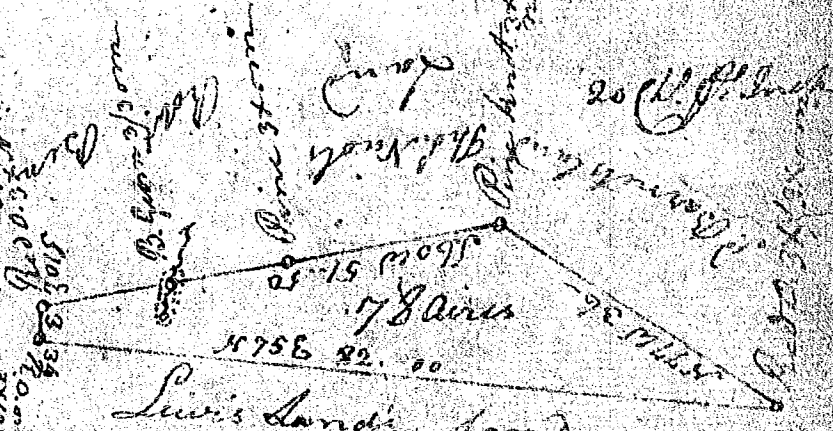

Lewis Land's land
 situated in Greeneville District, on both sides of a small
 branch of the Sugar River. Bounded to the N. E. on the
 side of Daniel Wilbanks & to the S. E. on the
 side of David Moore, & hath such shape, form, marks, &
 boundaries as the above plot represents, Dated this 4th day of Feb 1804
 Done this 6th Feb 1804 Del. self.