

South Carolina

251

Pursuant to a warrant  
 from John Thomas Esq. C. L. dated the  
 9<sup>th</sup> Jan<sup>y</sup> 1802, I have admeasured &  
 laid out to William Stringer a tract  
 of one hundred acres of land, situ-  
 ate in Greenville District on both sides  
 the N<sup>o</sup> Fork of Brasheers creek waters of  
 Rocky River bounded to the N<sup>o</sup> by lot  
 A. C. Stone's West<sup>ly</sup> by Samuel Towns land  
 to E<sup>t</sup> by land laid out not known  
 & hath such form & marks as the above plat represents

Ed. A. Stone land

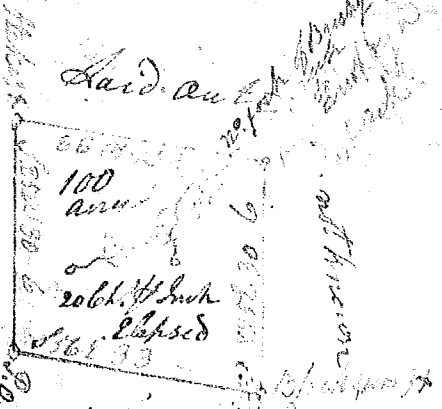

Survey the 11<sup>th</sup> day of January 1802 John Young Jun<sup>r</sup> Esq  
 Recorded for, & Elapsed by Elias Carle the 17<sup>th</sup> Sept<sup>r</sup> 1803

South Carolina

Pursuant to a  
 Warrant from John Thomas Esq.  
 C. Location, N<sup>o</sup> of Saluda River I  
 have caused to be laid out  
 to James Dobbin's a tract  
 of Eighty five acres of land  
 Situate in Newberry District on the  
 Waters of River & Saluda & hath such  
 Shape & measures as the above  
 plat represents  
 Certified this 27<sup>th</sup> Sept<sup>r</sup> 1803

Samuel Towns land

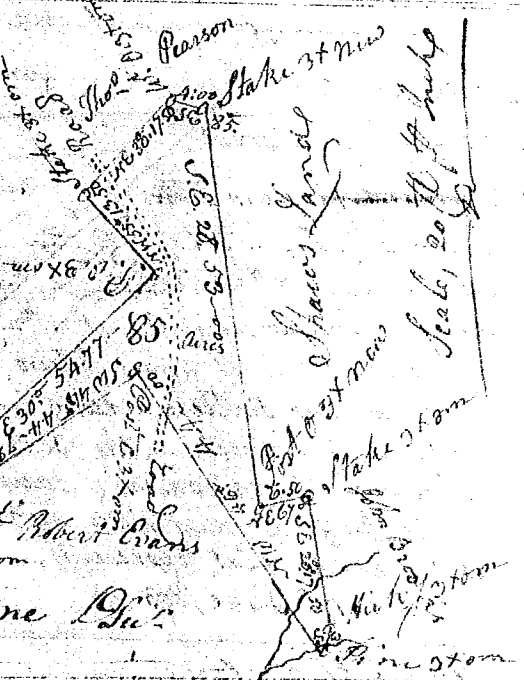

Douay Malone Esq  
 Recorded 3<sup>rd</sup> Oct<sup>r</sup> 1803

State of South Carolina Pursuant to a war-  
 rant from John Thomas C. L. dated  
 the 28<sup>th</sup> Sept<sup>r</sup> 1803 I have admeasured & laid  
 out unto John Thomas Jun<sup>r</sup> a tract of twenty  
 two acres of land, situate in Greenville Dis-  
 trict on the edge road about half a mile  
 from Milford mill - Bounding by lines  
 to wit N<sup>o</sup> E<sup>t</sup> by N. C. by John Thomas Jun<sup>r</sup> land  
 N<sup>o</sup> W<sup>ly</sup> land surveyed for John Clements &  
 Arthur Stafford & hath such form & marks as the  
 above plat represents. Survey this 27<sup>th</sup> day of Sept<sup>r</sup> 1803

Ed. A. Stone land

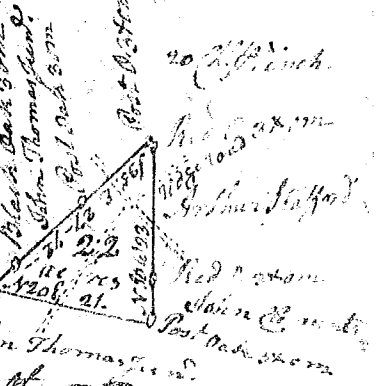

Recorded this 5<sup>th</sup> day of Oct<sup>r</sup> 1803

Wm<sup>o</sup> Thomas Esq