

South Carolina Pursuant to a warrant from John Thomas Esq. Comr. of loc. N. side Saluda dated 1st April 1800. I have admeasured and laid out unto William Hamilton a tract of two hundred and fifty acres of land in green-ville District, on the west fork of the R. Fork of French Broad River Bounding on Hawkins line and ing 3/4 on all other sides vacant Land, and hath such shape & marks as the above Plat represents. Survey. 10th April 1800, Recorded 18th April 1803

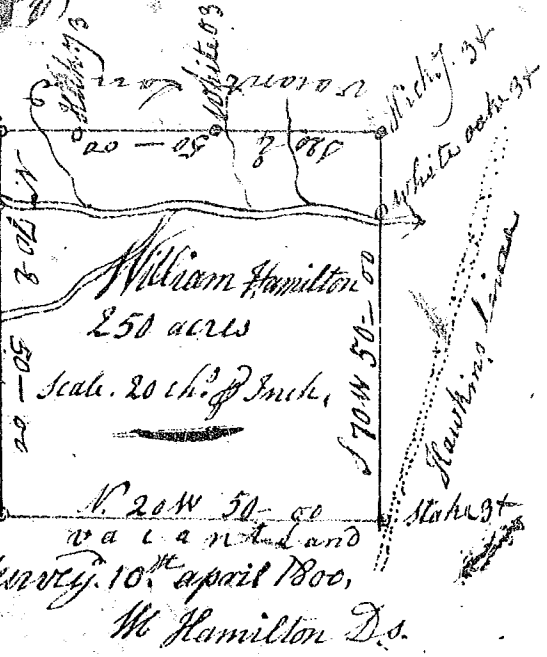

W. Hamilton D.S.

South Carolina Pursuant to a warrant to a warrant from John Thomas Comr. of loc. N of Saluda dated 8th April 1803. I have admeasured & laid out unto Denis Duff a tract of two hundred and sixteen acres of land in greenville District, on the waters of Chearora River waters of Saluda. Bounded N.E. by & N.W. by land out for Denis Duff, all other sides by vacant land, and hath such shape and marks as the above plat represents. Survey. 14th April 1803. Recorded 17th June 1803.



George Salmon D.S.

State of S. Carolina Pursuant to a warrant from John Thomas Esq. North of Saluda River Dated the 28th Oct. 1789. I have admeasured and laid out unto Essex Stanford, a tract of One Hundred acres of land situate in greenville County on both of Checharora (or the north) fork of Saluda River Bounded on all sides by vacant land & hath such form & marks as the above plat represents, Surveyed the 29th October 1789, Recorded the 13th Sept. 1803

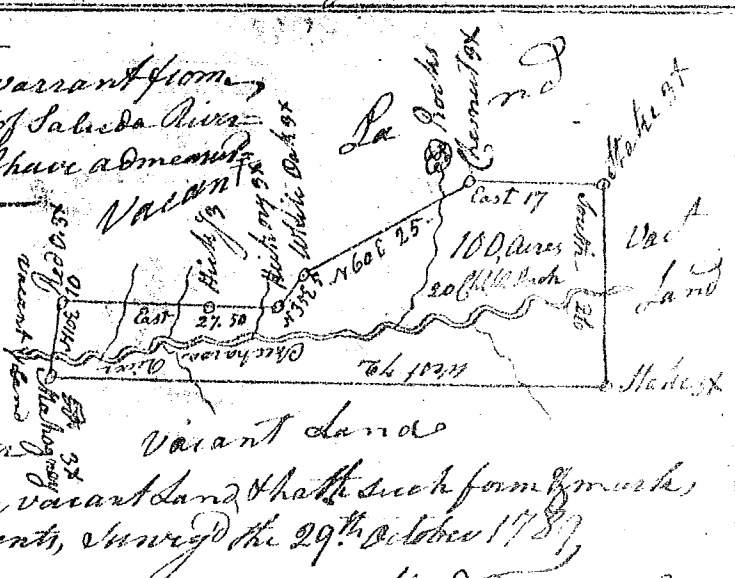

W. P. Thomas D.S.