

227 127
 South Carolina Pursuant to a warrant from John Thomas Comr of locs N side Saluda dated 11th Jan^y 1802, I have admeasured and laid out unto Johnson Ferguson a tract of Thirty Three acres of land in newberry District on a small branch waters of Sygar River bounded by lines running N 45° E. by land Survey for Thomas Hatcher, S. by a North Carolina Tract of land by land survey for James Crall, and both such shape & marks as the above Plat represents — recorded 16th Jan^y 1802 Survey 14th Jan^y 1802 John Nelson D.S.

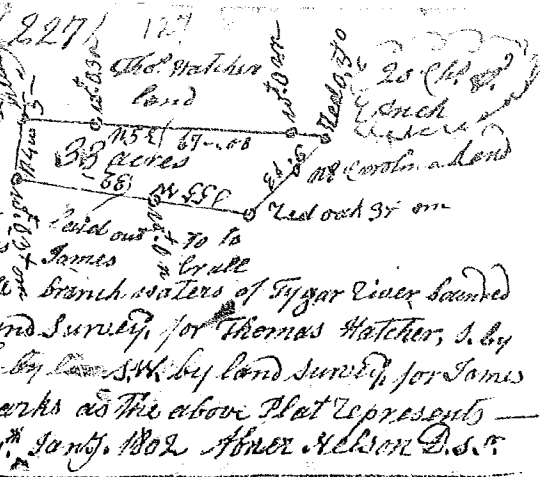

South Carolina Pursuant to a warrant from John Thomas Comr of locs N side Saluda dated 8th Jan^y 1802 I have admeasured & laid out unto Daniel Welch a tract of fifty five acres of land in greenville District on a small branch of Reddy river, bounded by lines running S 2° E. by James Broons land W. by Daniel Peden N. by Andrew Cooper land William Welch land, and both such shape & marks as the above Plat represents, recorded 25th Jan^y 1802 For Hilgore D.S.

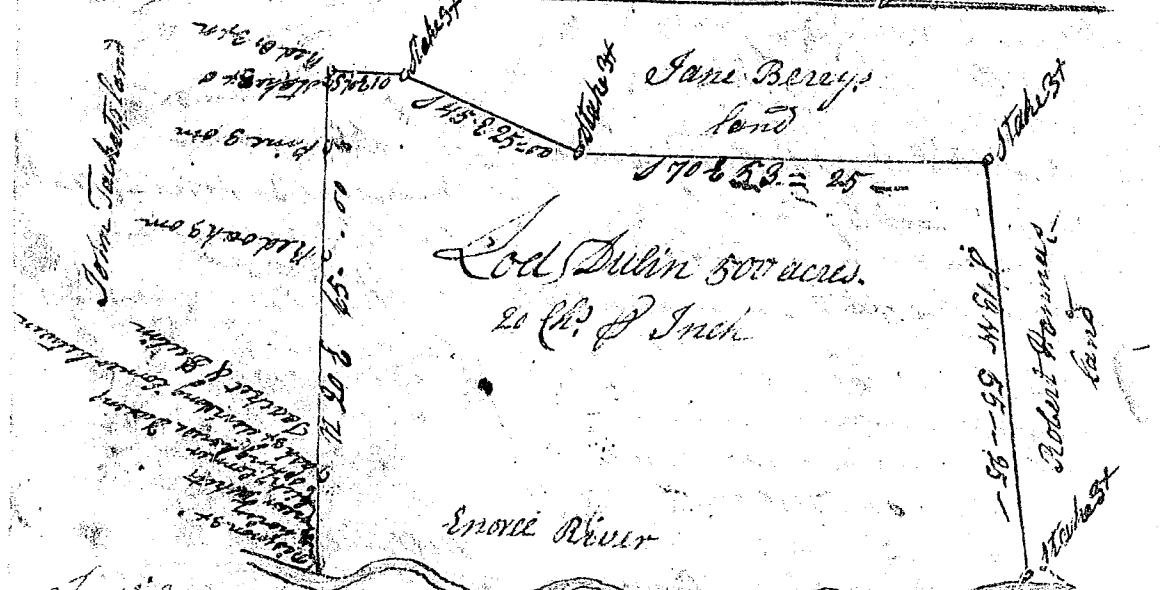
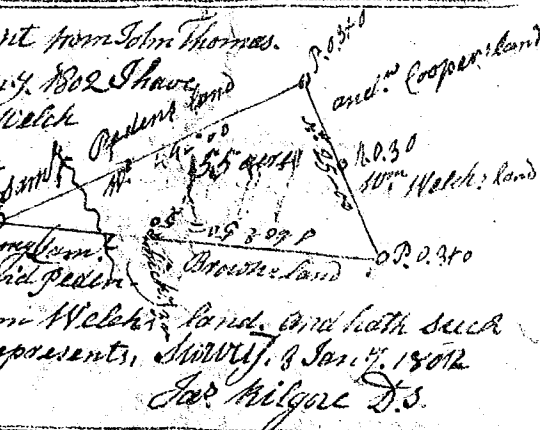

South Carolina Pursuant to a warrant from John Thomas Comr of locs N side Saluda dated 8th Jan^y 1802 I have admeasured and laid out unto Lodi Dulin a tract of five hundred acres of land in Spartanburgh District, bounding N side of Enore River N side by John Tachets land, N by Jane B. Swigs land E. by Robert Hannas land, including the plantation whereon said Lodi Dulin now lives on, and both such shape & marks as the above Plat represents — Survey 16th Jan^y 1802, recorded 20th Jan^y 1802 — For Hilgore D.S.