

South Carolina,

Pursuant to a warrant from John Thomas, Comr.

of the Court dated 28<sup>th</sup> Sept. 1802

I have laid out unto John

Nichols a tract of one

hundred & thirty eight

acres of land in Union

district on the S side of

Parolet River, bounded

E. & N. by John Nichols

land, W. by Robert Gibsons

land, S by Gordons

land, and hath such

shape & marks

as the above Plat

represents, Survey

11<sup>th</sup> Oct. 1802, Rich

Thomson D.S.

Recorded 19<sup>th</sup> Oct. 1802

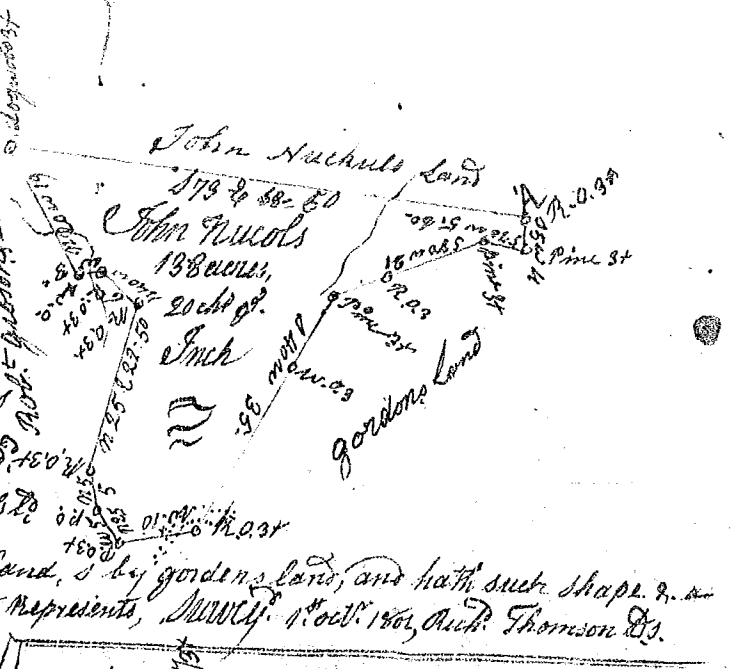

South Carolina Pursuant to a warrant from John Thomas, Comr. of the Court

dated 10<sup>th</sup> Oct. 1801 I have admeasured & laid out unto William Oneal

a tract of one hundred and fourteen acres of land in Laurens District

on the branches of Beaver dam creek & Little river cutting and bounding

as the above Plat represents Survey 8<sup>th</sup> Oct. 1801

Recorded 22<sup>nd</sup> Oct. 1801



South Carolina Pursuant to a warrant from John Thomas, Comr. of the Court

dated 10<sup>th</sup> Oct. 1801 I have admeasured & laid out unto William

Gayley & Gabriel Benson a tract of six hundred & ten acres of

land in Spartanburgh District on Fortinbories beaver dam

creek & Sugar river bounded by line

bet. Stanfords land, S. Augustin Clusters, N.E. Col. Taylor's

land, N.W. James Vernons land N.W. by William Gayley's

land, and hath such shape & marks as the above Plat

represents Survey 25<sup>th</sup> Sept. 1801

