

South Carolina, Pursuant (99)
 to a warrant from John Thomas Esq;
 of the N. side set out in the
 said warrant I have admeasured
 and laid out unto John Gordon
 a tract of seventy acres
 of land in Union District
 on a small branch Creek
 of Snow River bounding
 N.E. on a survey
 for Robert March N.W. on land
 laid out for John Taylor Esq. on Jose Pold
 S.E. on John Naderman and the heirs of Thomas Harris; Land
 and hath such shape and marks as the above Plat represents.
 Survey 22nd Jan^y 1801. Robert Hanna Esq.
 Recorded 18th July 1801.

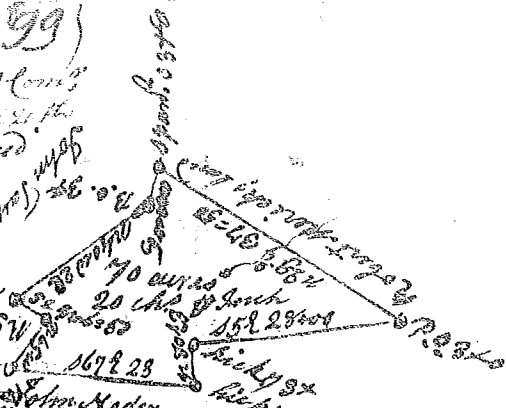

State of South Carolina, Pursuant to a warrant
 from John Thomas Esq. (cont. of copy N side of
 saluda dated 1st May 1801. I have admeasured
 and laid out unto John B. Danice a tract
 of forty acres of land, on the south side
 of the Middle fork of Tigger River, bounding
 along running N.W. by the heirs of Joseph
 Weisbath Dec. N.E. by Nathaniel Malhers
 land S.E. Dyson's land N.W. N.E. by the
 heirs of Joseph Weisbath Dec. Northward by
 by said Middle fork of Tigger river,
 and hath such form and marks as the above
 Plat represents, Survey 1st May 1801.
 Recorded 1st Aug^t 1801.

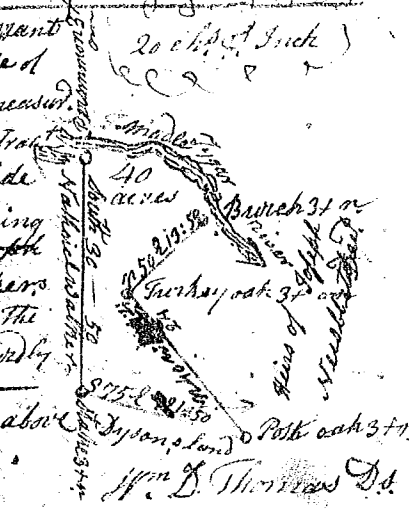

South Carolina, Pursuant to a
 warrant from John Thomas Esq.
 I have admeasured and laid
 out unto Thomas Hancock a tract
 of eighty one acres of land, in
 Union District on branches of fair
 forest creek of Tigger River, bound
 N. by George Thompson's land N. by
 unknown land W. by Josep Daird's
 = sons land, S. by N.W. N.E. by
 = Cormick's land, and hath such
 shape and marks as the above Plat represents
 Survey 30 June 1801. Rich^d Thomson Esq.
 Recorded 14th Aug^t 1801.

