

South Carolina

pursuant to a warrant from Wm. D. Thomas Commissioner of Locations in the District of Greenville dated the 4<sup>th</sup> Day of February 1814 I have admeasured and laid out into John Lovel a tract of land containing fifty acres

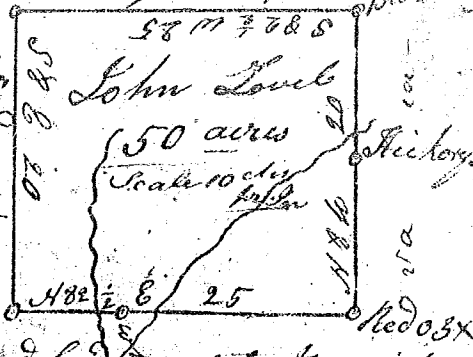

situate in the said District on branches of the Devils fork Creek Waters of the Middle fork of Saluda River bounded by a line running N 82 1/2 E by land Survey for Jeremiah Neisbet and on all other Sides by Vacant land & hath such form & marks as the above plat represents, Surveyed the 5<sup>th</sup> Day of Feb 1814 Recorded the 6<sup>th</sup> of August 1814 W. H. Cooke & S. returned to Surveyors office

Chair Carriers  
Luke Williams  
Mark Williams

South Carolina

pursuant to a warrant from Wm. D. Thomas Commissioner of Locations for the District of Greenville dated the 4<sup>th</sup> Day of February 1814, I have admeasured and laid out into Luke Williams a tract of land containing forty six acres

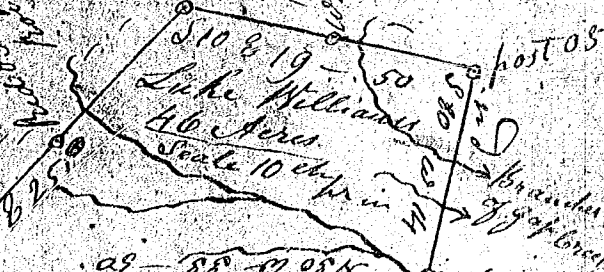

situate in the said District on branches of Cup Creek & Fall Creek waters of the Middle fork of Saluda River bounded by a line running N 10 2 1/2 W by Joseph Williams land & on all other Sides by Vacant land & hath such form & marks as the above plat represents, Surveyed the 16<sup>th</sup> Day of February 1814

Recorded the 6<sup>th</sup> Day of August 1814 W. H. Cooke & S.