

To S<sup>c</sup> Carolina Pursuant to a (25)  
 Greenville District Warrant from Wm. Thom<sup>s</sup>  
 same directed dated January 19<sup>th</sup> 1805  
 I have ~~measured~~ measured  
 laid out unto Benjamin  
 Pollard junr, a tract of land  
 containing seventy six acres  
 in Greenville District on a branch  
 of Reddy River, having such  
 shape, marks, boundings & buttings  
 as ~~are~~ represented by the above  
 Plat. Surv<sup>d</sup> the 21<sup>st</sup> Jan<sup>y</sup> 1805  
 Recorded 25<sup>th</sup> Feb<sup>r</sup> 1805 J. H. Harrison Dist<sup>o</sup>

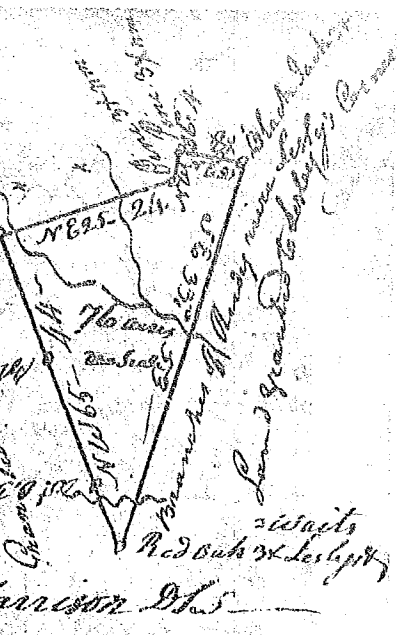

S<sup>c</sup> Carolina Pursuant to  
 a warrant from  
 Wm. D. Thomas Esq<sup>r</sup> C. C.  
 in Greenville District  
 dated the 21<sup>st</sup> Dec<sup>r</sup> 1804  
 I have admeasured & ab  
 laid out unto John  
 Watson, a tract of Fifty  
 four acres & an half situate  
 in said district, on Frohock  
 Creek, Waters of South Tygar  
 River &c. By a line running  
 S E by land Survey'd for John Watson  
 & Wm. D. Thomas. N W by land Survey'd  
 for John Thomas junr. & hath such  
 form & marks as the above represents  
 Survey'd the 21<sup>st</sup> Dec<sup>r</sup> 1804  
 Recorded this 20<sup>th</sup> March 1805

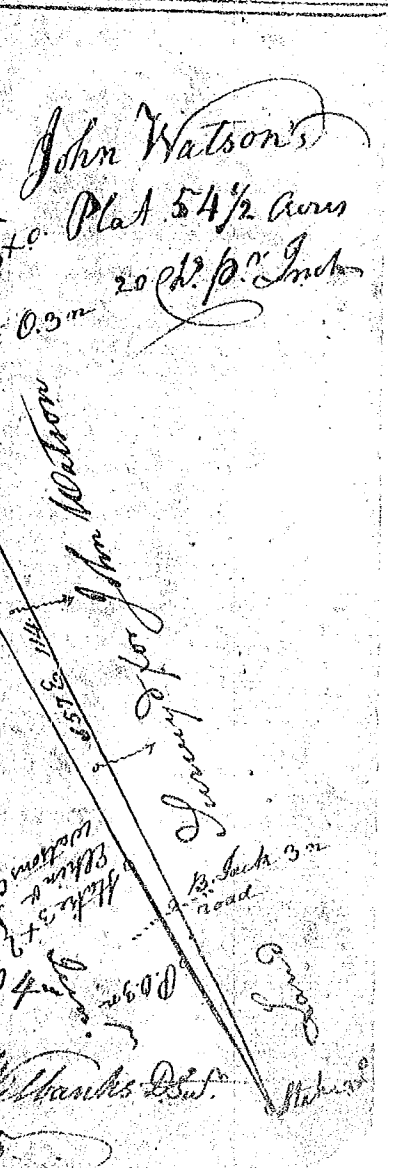

Survey'd the 21<sup>st</sup> Dec<sup>r</sup> 1804  
 Recorded this 20<sup>th</sup> March 1805  
 Dan. McPherson Dist<sup>o</sup>