

South Carolina  
 Pursuant to a warrant  
 from John Thomas, Comr.  
 of both sides saluda  
 dated 1<sup>st</sup> Oct. 1799 I  
 have surveyed for  
 James Smith a tract  
 of four hundred and  
 sixty acres of land in  
 Spartanburgh County  
 Pinckney District, on branches  
 of Fairforest Creek & Kelson  
 Creeks on both sides of  
 the courthouse road five  
 miles below said courthouse, bounded N. Smith & his wife's lands, E. & South  
 by Smith's land, W. by land belonging to Robert Legan, and heath  
 such shape & marks as the above Plat represents. Survey 5<sup>th</sup> Oct. 1799,  
 Recorded 21<sup>st</sup> Oct. 1799, —

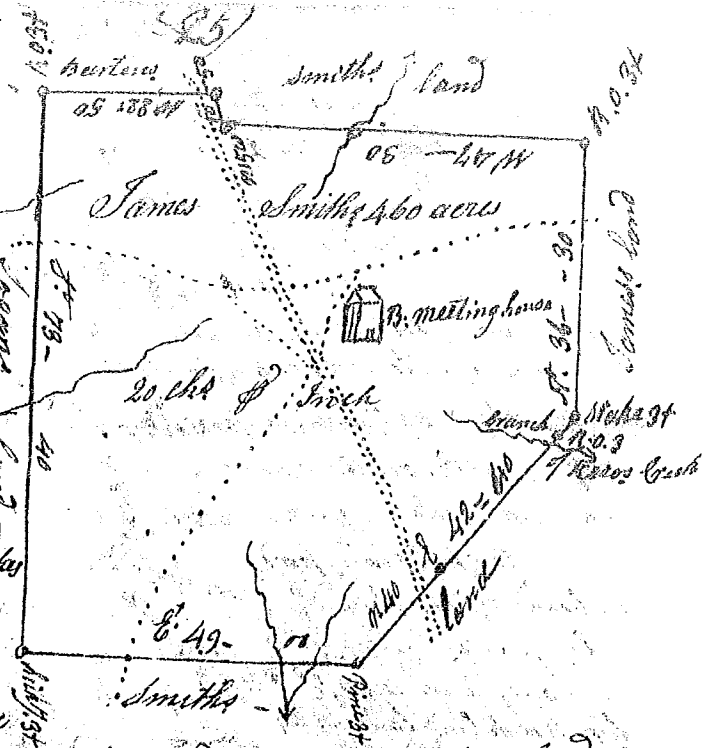

South Carolina,  
 Pursuant to a  
 warrant from John  
 Thomas, Comr. of both  
 sides saluda dated  
 25<sup>th</sup> Sept. 1799 I  
 surveyed for as  
 Nelson a tract of  
 354 acres of land  
 in Spartanburgh  
 County Pinckney District  
 on the west side of both  
 Creeks & his wife's creek  
 both of which rivers bound  
 W. by John Nelson's land  
 E. by Cantrell's land W. by Major  
 Cantrell's line  
 land, S. by Vacant land, and with such shape, marks, bearings  
 and boundaries as the above plat represents. Survey 28<sup>th</sup> Sept. 1799,  
 Recorded 2<sup>nd</sup> Oct. 1799, —

