

South Carolina

Pursuant to a Warrant from John Thomas Esq. Comr. Genl. dated 29 July 1799 I have admeasured and laid out unto John Heyington a tract of two hundred & twelve acres of Land situated in Greenville County on the branches of Wolf's Creek of the Middle fork of Saluda River and a branch of Shell Creek of the North fork of Saluda River bounded south by vacant Land East & S. wardly by J. Cobbs Land Vacant Land and by John Youngs Land N. wardly by Vacant Land N.W. wardly by Land laid out for Joseph Dennis and Vacant Land S.W. wardly by Land laid out for Jesse Mansfield and both such Shapes & Marks as the above plat represents

Recorded 29 Aug 1799 Survey 1<sup>st</sup> day August 1799

George Salmon Esq.

State of S. Carolina

Pursuant to a warrant from John Thomas Esq. Comr. Genl. No. of Saluda River: bearing date the 30<sup>th</sup> August 1799 I have admeasured & laid out unto John Chandler, a tract of Land Cont. of Ninety Acres, situated in Greenville County, lying on the waters bounds of Wm. Young's Lot, Ship's Land, S. C. Joel Chandler, N. E. on Larkin Ragsdale's of Rudy River & both such form and marks as the above plat represents Survey the 2<sup>nd</sup> Sept 1799

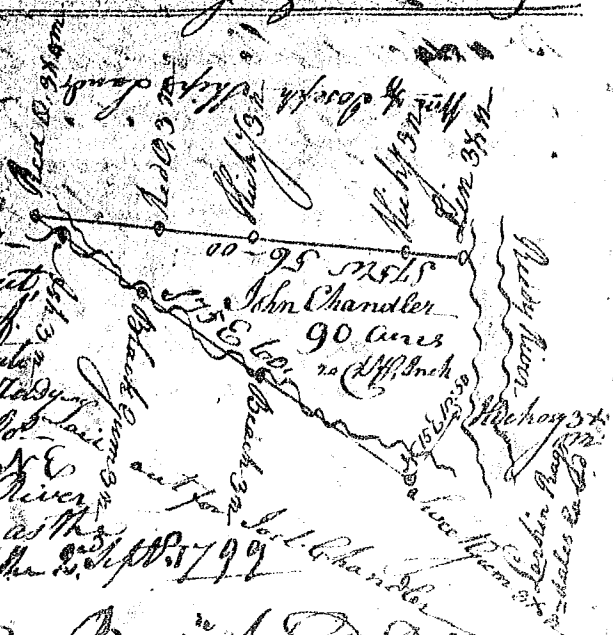

Recorded the 5<sup>th</sup> Sept 1799 & Conj. Arnold Esq.