

This plot of 545
 acres of land laid out
 for Elijah Mitchell
 on the branches of
 Cain Creek bounded
 as to Plat. Survey.
 21st Nov. 1796.
 by John Rodgers, D.S.
 recorded 6th Nov. 1796.

John 242 Naffley
 09 - 86
 73
 Elijah Mitchell
 545 acres.
 20th Feb. 1797

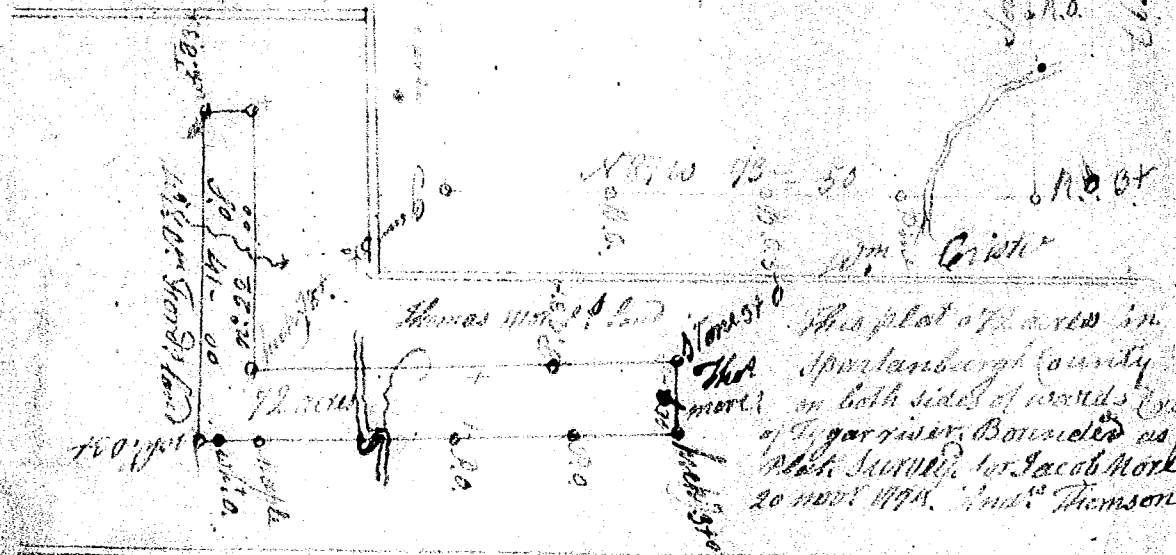
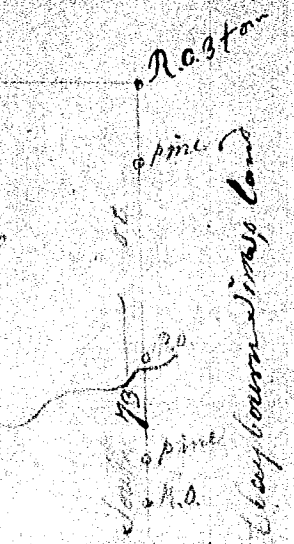

In compliance pursuant to a warrant from Sebastian... dated the 11th July 1803 I have...
 1803

George Salmon

The 23rd August 1803