

This Plat of 304 acres was laid out for Claytown Sims on the Beaverdam Creek of Little river, having such marks, bearings & bounding as the above Plat represents, Survey by Robt Hanna D^r 1796

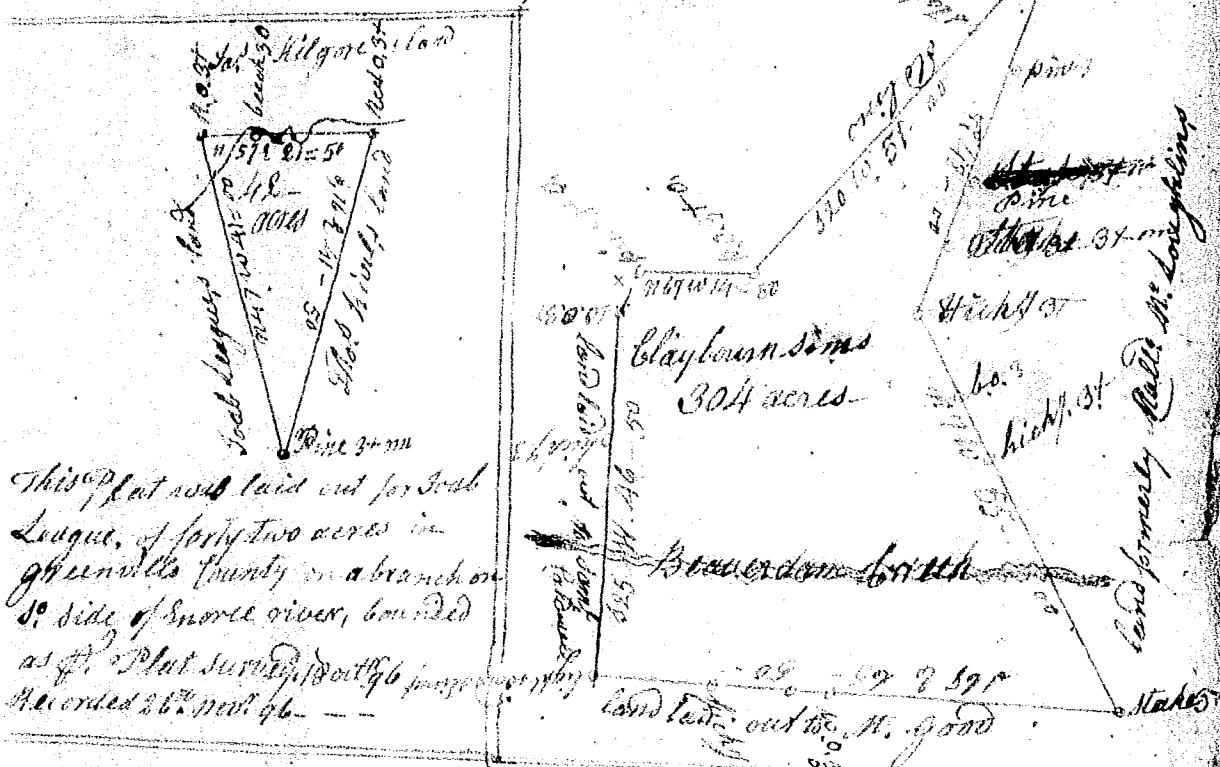

This plat was laid out for Jack League, of forty two acres in greenwills county on a branch on S^o side of Snowe river, bounded as the Plat surveyd out 96
Recorded 26th Nov 96

This plat of 213 acres of land surveyd for David Whitford in Laurens County on the waters of Cain Creek, waters of Saluda river, bounded as the Plat surveyd 25th April 1797 -
Recorded William Hunter D^r

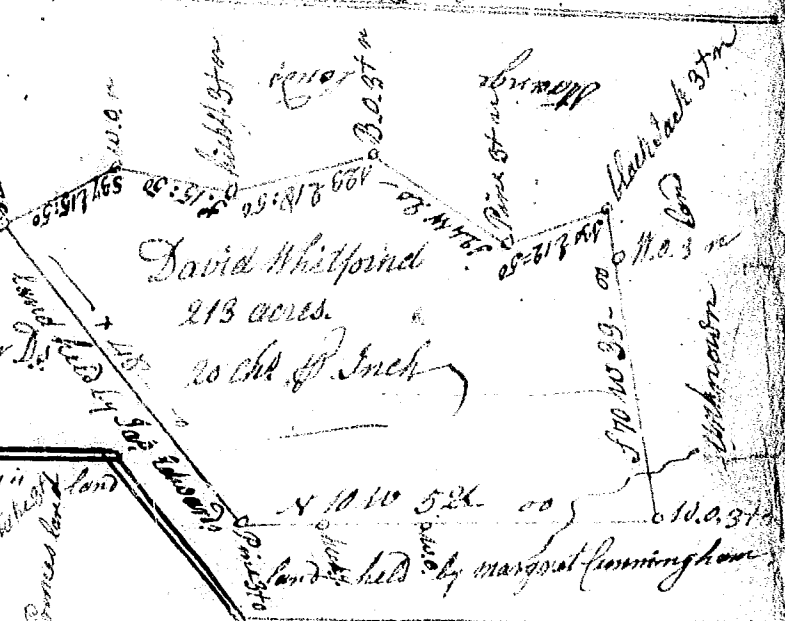

David Whitford
213 acres
20 ch^o of Inch

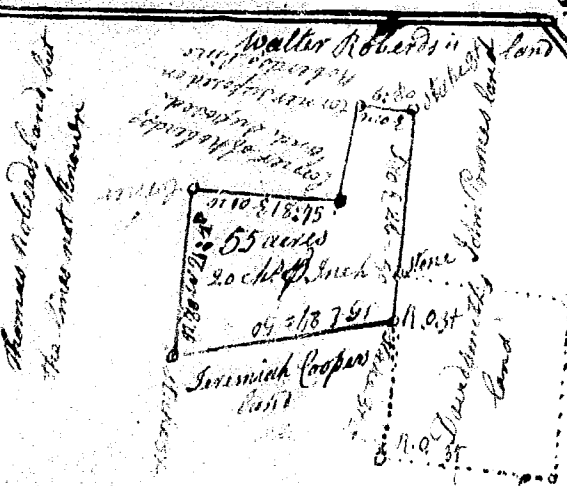

This plat of 55 acres was surveyd for David Smith Jun^r in Union County on the Ridge between Pequet's Creek & Snowe River, bounded as the Plat annexed, Survey 2^o Oct^r 1797 A. Pearson, D^r Recorded 10th Nov^r 1797