

This tract of 51 acres in Laurens (221)
 County on Quaker branch of Little
 river was surveyed on the 21st day
 of October 1795 by
 John Hunter D^s
 Recorded 3 Nov. 1795

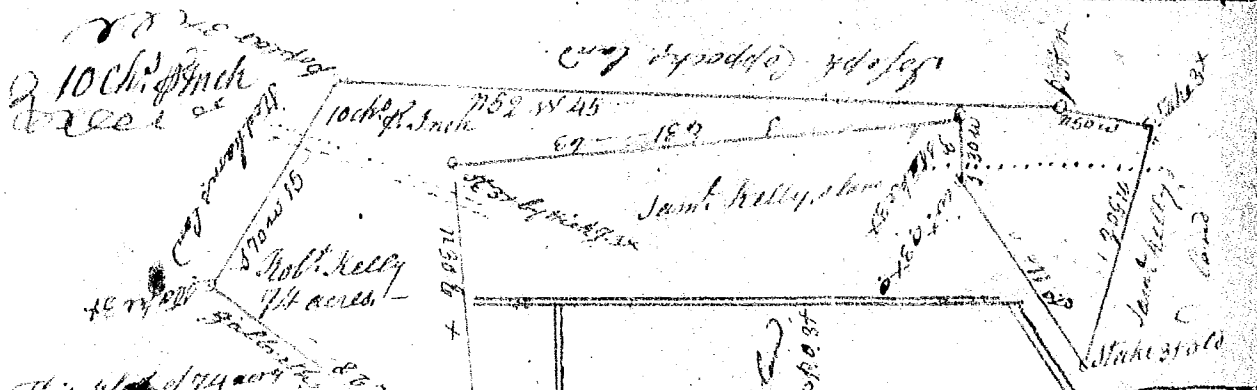

This plot of 74 acres of land in Newberry County on back creek in the fork between Broad & Saluda rivers the 13. Dec. 1795 by Wm Knight D^s.

The annexed plot of 130 acres of land was surveyed for Wm Higgins in a small branch of Beaver Dam Creek of Enoree River in Laurens County bounded as follows Surveyed 20 Dec. 1795 Robt Hannan D^s.

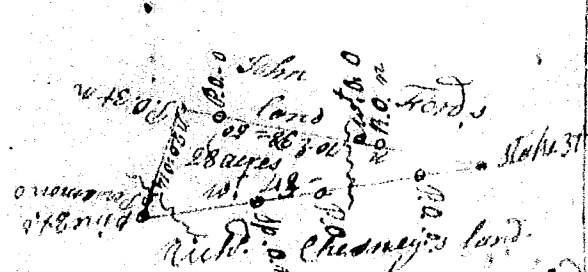

This plot of 28 acres was laid out for John Ford in part of Newberry County on the branches of Two-mile Creek waters of Enoree River bounded as follows Surveyed May 1797 Jas Wofford



This plot of 56 acres of land was surveyed for John Smith in part of Newberry County on the branches of Two-mile Creek waters of Enoree River bounded as follows Surveyed 10. Dec. 1795 Andrew Morrison D^s