

S^c Carolina, Pursuant to a warrant from John Thomas (S^c M^c Clerk & C^o Saluda. I have admeasured & laid out unto Henry West, a tract of five acres of land in Newberry Count between the waters of Canon Creek and Sains Creeks waters of broad river, and hath such butting as the annexed plat represents Certified 14th April 1794: George Humbert Esq. Recorded 19th Sept^r 1794, -

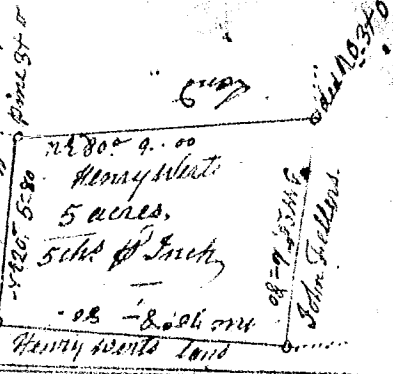

S^c Carolina Pursuant to a warrant from John Thomas dated 14th April 1794, I have admeasured and laid out unto Michael Mc Kee a tract of 167 acres of land in Newberry County on a small creek (called Lowrys Run of Little River) Saluda, with such form and Parks as the annexed plat represents. Certified 25th April 1794 - R. Brown Esq. Recorded 14 April 1794.

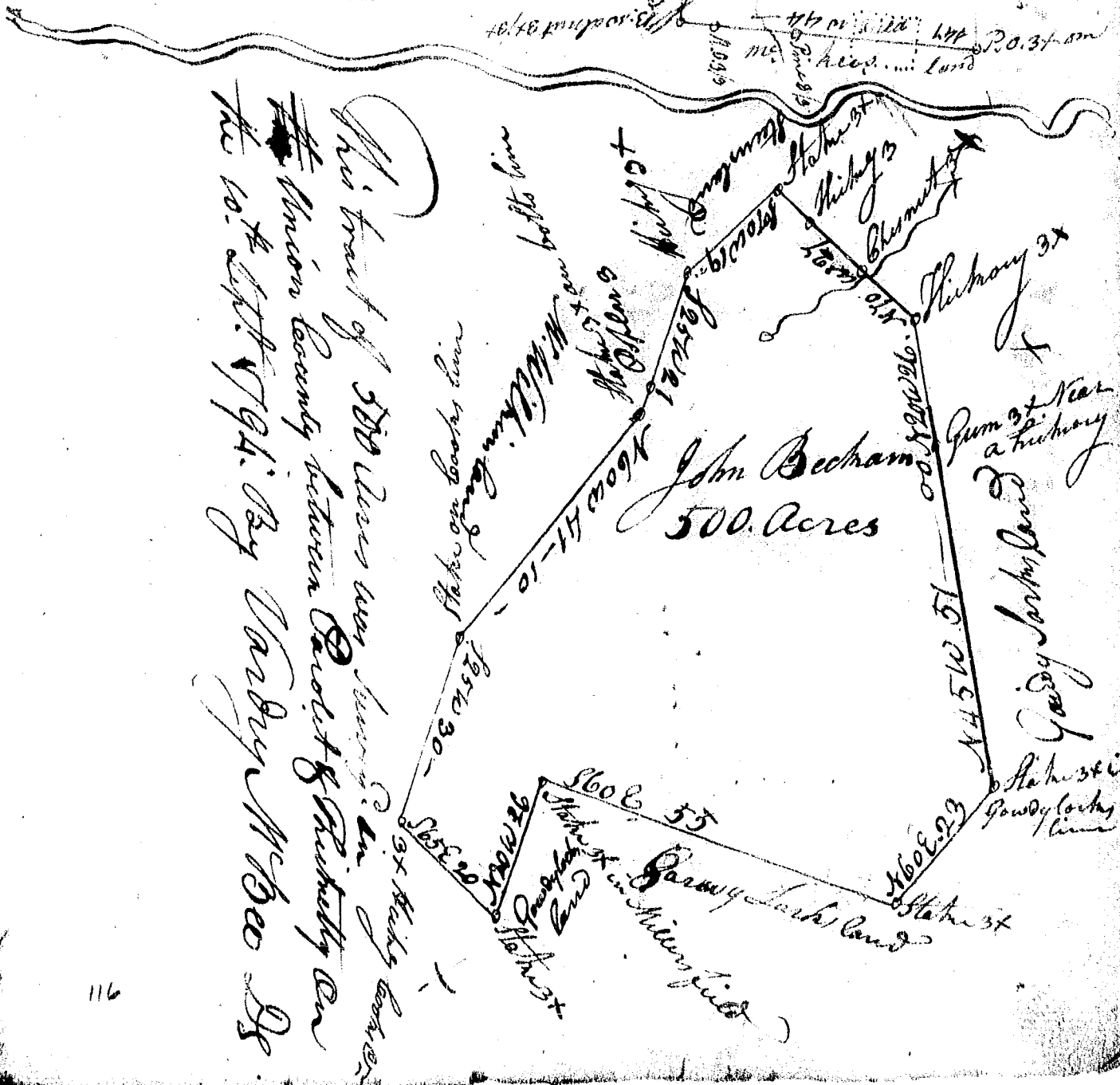
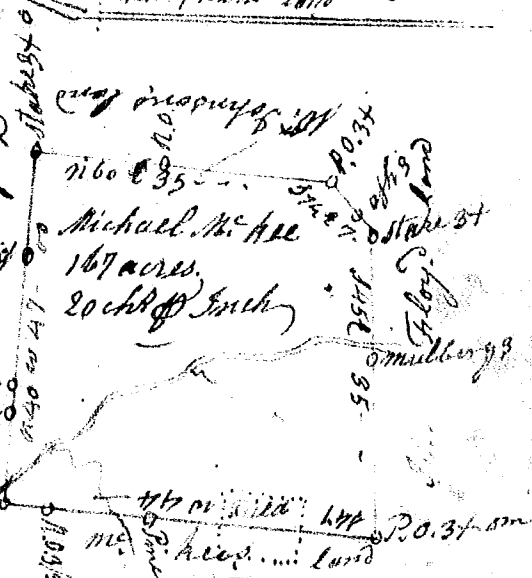

This tract of 500 Acres was Surveyed in the Newberry County between Carolina & South Carolina the 10th Oct^r 1794. By Landry Mc Bee Esq.