

S<sup>o</sup> Carolina } Pursuant to a warrant from John Thomas Esq. Com<sup>r</sup> of  
 Locations dated the 10<sup>th</sup> Feb. 1794. I have admeasured and laid out unto Rich.  
 Fowler a tract of One hundred and seventy & a Acres of land on the S<sup>o</sup>  
 Branches of Derbins Creek in Greenville and Laurens Countys, Bounded  
 by a line Running S. 65 W. 52,50 links on Rich. Fowlers Land, and hath  
 Such other Courses, Marks, Boundaries and Form as the above plat doth  
 Represent— Surveyed the 10<sup>th</sup> day of Feb. 1794—

James Kilgore Esq

S<sup>o</sup> Carolina  
 Pursuant to a warrant  
 from John Thomas Esq Com<sup>r</sup>  
 of Locations N<sup>o</sup> Saluda dates  
 the 13<sup>th</sup> Feb. 1794 I have ad-  
 measured and laid out unto  
 Stephen Howard a tract  
 of three hundred and thirty  
 seven acres of land in  
 Greenville County on  
 Horsepin Creek Bound-  
 ed By a line Running  
 S 33 W 70 Chains on  
 Jacob Daviss Land &  
 hath Such other Courses

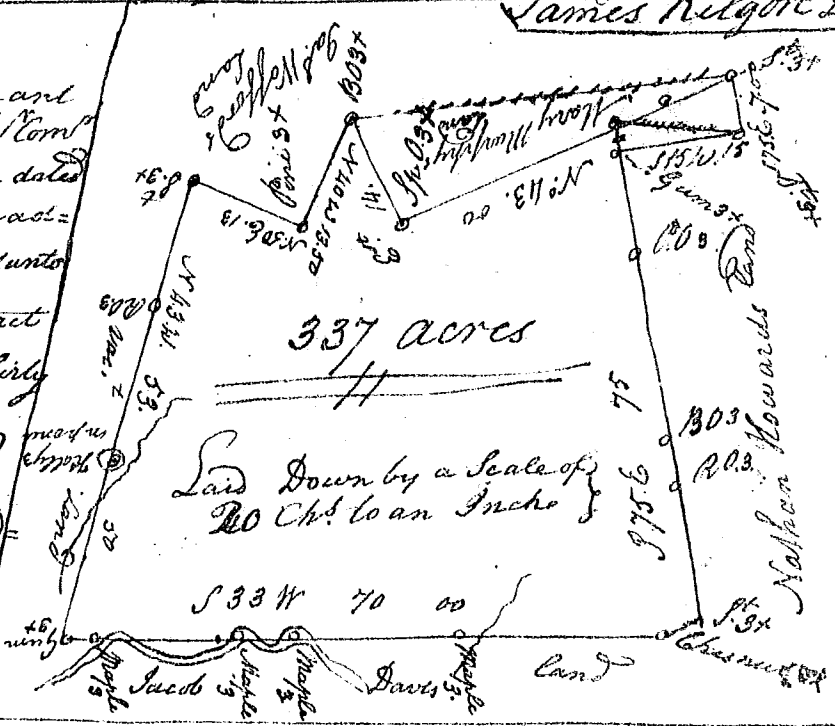

Boundaries Marks and form as the above plat Represents— Surveyed  
 the 13<sup>th</sup> day of Feb. 1794— James Kilgore Esq