

Laid down by a Scale of 20 Chains to an Inch

S. Carolina Pursuant to a warrant from John Thomas Esq. J. J. Archney District Com. of Locations No. Saluda dated the 10. January 1793 I have admeasured and laid out unto Isaac Crow a tract of four hundred & ninety acres of Land in Spartanburg County and on the branches of two Mile Creek & James Creek Bounded to the N.E by Richd. M. Clunkins Land & to the N. by Charles Durnums Land westerly by vacant land & William Claytons Land & to the S. by William Crow's Land & to the S.E. by Old lines the owner unknown and by the S. Isaac Crow's Land and hath such Shape & Marks as the above plat Represents — Surveyed the 24. day of January 1793.

Andrew Thompson Esq.

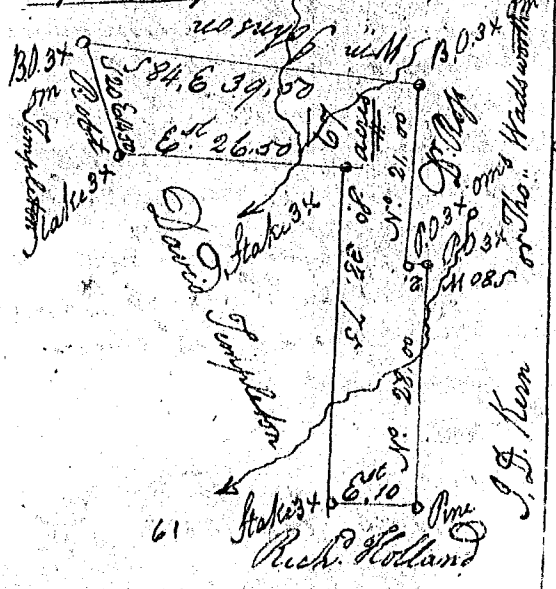

S. Carolina Pursuant to a warrant from John Thomas Com. of Locations No. Saluda dated this day I have admeasured & laid out unto David Templeton a Tract of Sixty seven acres of Land on a Small Branch of Duncans Creek in Laurens County Bounded S. on Richd. Holland. E. on J. D. Kersh and D. Ross, N. on Wm. Johnson S. E. on Robert Templeton S. & W. on S. David Templeton, and hath such Shape & and Marks as the above plat Represents Survey'd y. 2. Feb. 1793 Rob. Scanlon Esq.