

By a Scale of 200
Chains to an Inch.

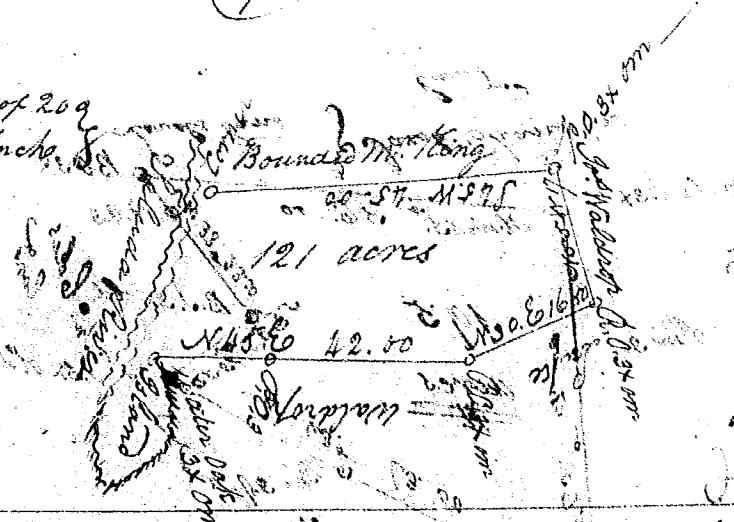

South Carolina
Laurens County
Pursuant to a warrant from John Thomas
Esq. Comm^r of Locations N^o Saluda Bearing
date the 1st day of Oct^r 1792 I have admeasured & laid out
unto John Maxwell a tract of One hundred & twenty one acres
of Land Bounding on the N^o Side & to the N^o W^o on M^o Kings
and E^o on Joseph & Luke Watergo and hath such shape
& marks as the above plat Represents
Surveyed the 3^d day of Oct^r 1792
John Rodgers D^s

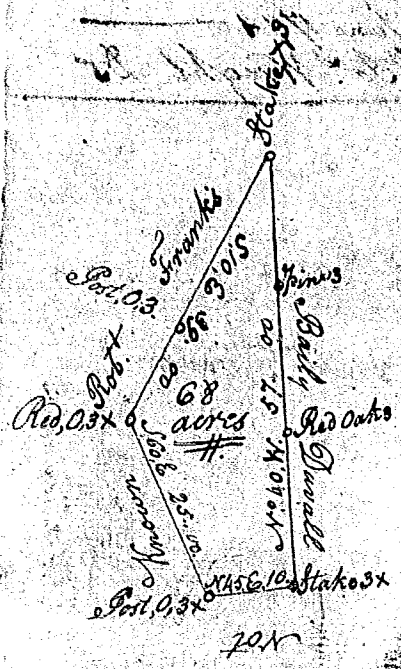

By a scale of 200
Chains to an Inch.

South Carolina
Laurens County

Pursuant to a warrant from
John Thomas Esq. Comm^r of Locations N^o
Saluda River, dated the 3^d day of Nov^r
1792 I have admeasured and laid out unto
John Creech sixty eight acres of Land
on a Branch of Duncan's Creek the waters
of Broad River Bounding E^o on Bailey
Duvall W^o on Robert F. Hanks S^o not
known & hath such shape and marks
as the above plat Represents.

John Rodgers D^s