

North Carolina Pursuant to a
 warrant from John Thomas
 Comr. of the N. Saluda
 dated 14 May 1796 - no. 450
 I have admeasured
 and laid out unto
 William Hammond
 abstract of 200 acres
 of land in Laurens
 County on branch of
 of woper & Beaver
 dam creeks, bounded E on Lewis
 Hammonds land N.W. on John Simons
 and Peter Hammonds lands W on John
 Robertsons land S.E. on Henry
 Lindser, and with such shape & marks
 as the above plat represents.
 Survey of 28th May 1796 - Jonathan
 Towres, D.S.
 Recorded. J. M. Hanna No Date.

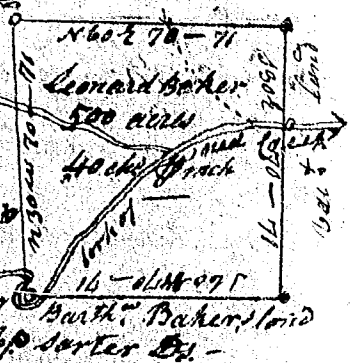

North Carolina Pursuant to a warrant
 from John Thomas Comr. of the Saluda
 dated 28th June 1797 I have laid out
 Leonard Baker abstract of 500 acres
 of land in Union County on the
 water of Neels big creek bounded
 line running N.W. by west land N.E. by
 Charles Sims land S.E. by west land
 S.W. by Barth^l Bakers and with
 such shape &c as the above plat
 represents. Survey of 5 July 1797 - J. P. Switzer D.S.
 No time of Record.



North Carolina Pursuant from John Thomas
 Comr. of the Saluda dated 28th June 1799 I have surveyed
 for Henry Noble abstract of 132 acres in Union
 County on the water of Neels Creek bounded
 line running N.E. by land survey for Gabriel
 Brownland all other sides N.W. and with such
 shape & marks as the above plat represents.
 Survey of 1st July 1799 - J. P. Switzer D.S.
 No time of Record.

