

State of S. Carolina

Pursuant to a warrant from John Thomas Esq. Com. of Locations, I have admeasured and laid out unto John Kinsland a Tract of One hundred Acres of Land Situated in Ninety Six District on the West Side of Tygar River, adjoining the same Bounding by lines running S.W. & N.W. on Gachamiah Estes's Land, by lines running N.E. on James Hawkins's Land & by lines S. & E. on Thomas Biddies Land and hath such Shape & marks as the above plat Represents.

Surveyed the 7th day of Sept. 1793

D. Hopkins D.S.

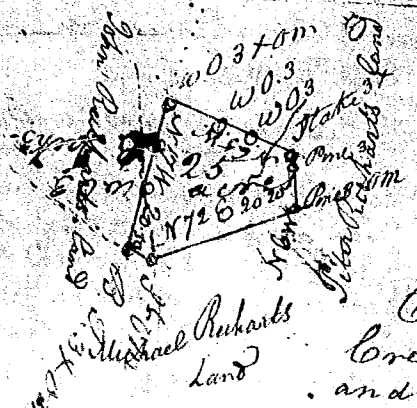

S. Carolina
 Pursuant to a warrant from John Thomas dated the 13th day of Sept. 1793 I have admeasured and laid out unto Martin Charles a tract of twenty five acres of land in Newberry County on a Branch of Cannons Creek Bounding N.W. on Peter Richards's Land and S.W. & N.E. on Lawrence Harris's Land and hath such Shape & marks as the above plat Represents

Surveyed the 31st Day of Dec. 1793

David Ruff D.S.