

56

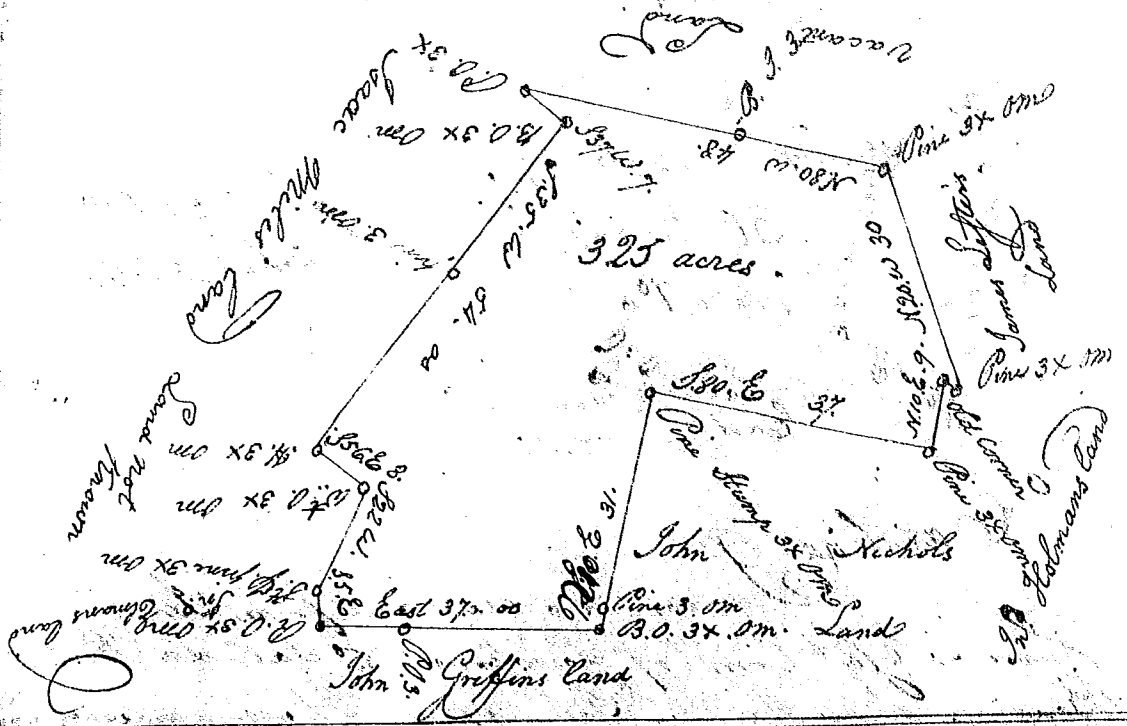

St. S. Carolina
 Pursuant to a warrant from John Thomas Commissioner of Locations No Saluda, dated the 27th day of May 1792. I have admeasured and laid out unto James Pally a plantation or tract of three hundred & twenty five acres of Land and hath such Shape, Marks, Boundings & Bounding as the above plat Represents, Certified for the 13th June 1792
 By P. Waters

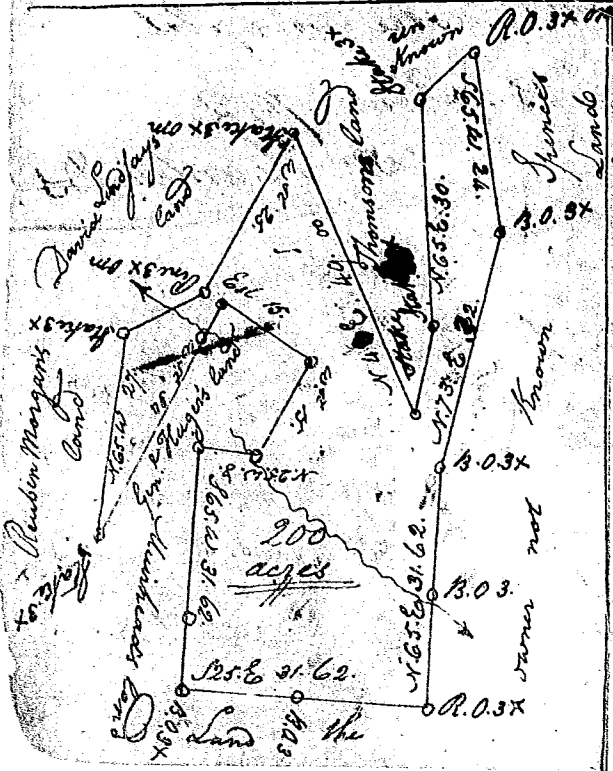

State of S. Carolina
 Pursuant to a warrant from John Thomas Esq. Commissioner of Locations Bearing date the 27th day of May 1792. I have admeasured and laid out unto Philemon Waters a plantation or tract of two hundred acres of Land on the waters of Whites Branch, Big Creek, & Cannons Creek and hath such Shape form & marks as the above plat Represents.
 Certified for the 14th June 1792
 by P. Waters