

(53)

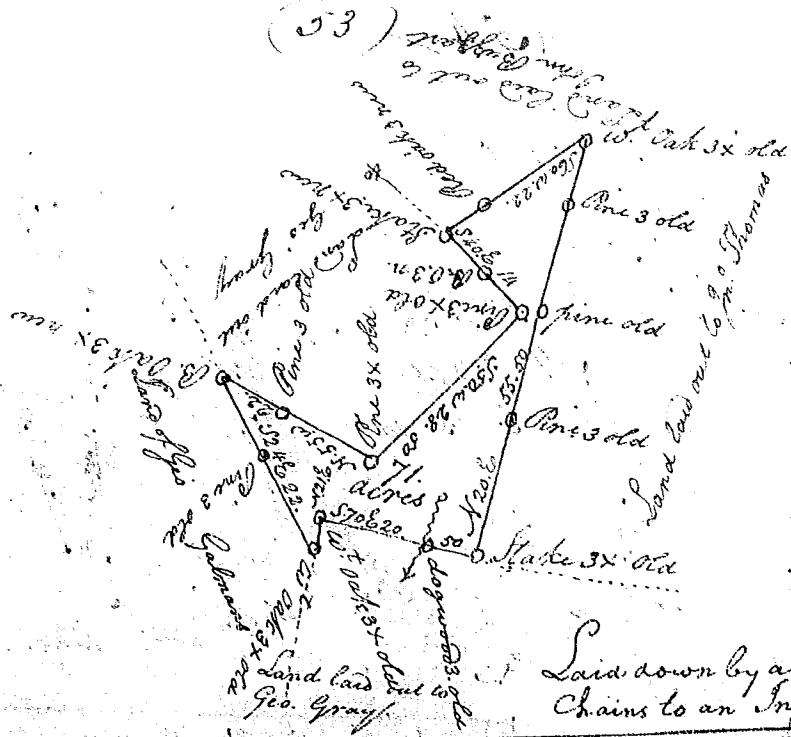

Laid down by a Scale of 20 Chains to an Inch.

S. Carolina } By a warrant from John Thomas Esq. Com^r of
 Newbury County } Locations, to me directed, I have admeasured and laid
 out unto Frederick Gray a plantation or Tract of Land containing
 Seventy One acres situate lying and being in S. County on the waters
 of Cannon Creek and hath such shape form & marks as the above
 plat Represents. Certified for the 26th May 1792.

David Ruffe D^s

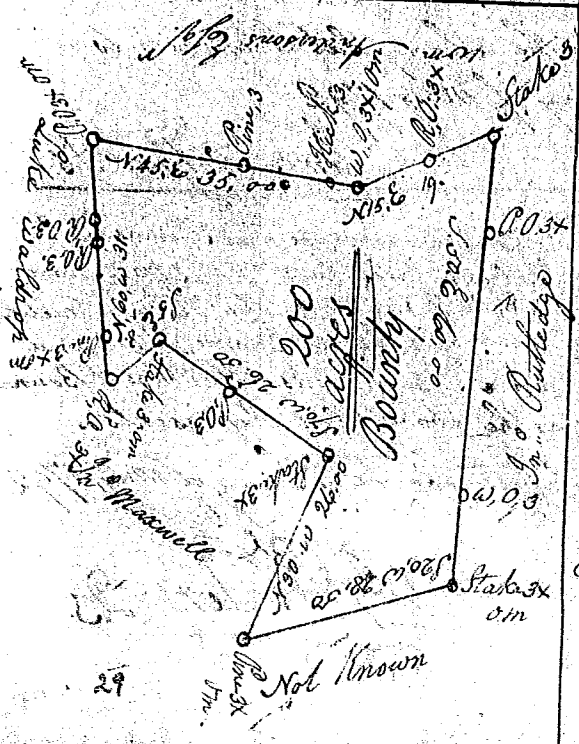

S. Carolina Laurens County
 Pursuant to a warrant from
 John Thomas Esq. Com^r of Locations, New
 Saluda dated the 20th February 1792
 I have admeasured and laid out unto
 Joseph Waldrop a Soldier in the continent
 Line of the State a Tract of two hundred
 acres of Land on the head branch of Walnut
 Creek of the Branches of Saluda River
 Bounding S. on J^r Maxwell & Luke
 Waldrop W. on Wm Anderson Esq. S. on
 on John Rutledge Esq. The other Sides
 Not known & hath such shape & marks
 as the above plat Represents.
 Surveyed the 5th Day of March 1792

John Rodgers D^s