

PP 486

South Carolina Pursuant to a warrant from John Thomas, Comr of Land & Survey dated 15th April 1799, I have admeasured and laid out unto James Galt's tract of Two hundred and seventeen acres of land part in Union County & part in Meschery County, in Pinkney & 96 Districts on Snow River including Peningtons Sholes, bounded by a line running S 26 W by John Lps. land, S 45 E by land survey, Peter Bräselmann Part by Charles Kemets land, N 9 E by South's Luads land, S 58 W by Charles's land, N 50 W by the River to the beginning, and hath such shape & marks as the above plat represents Survey 15th April 1799 - A. Pearson D.S.
Recorded 17th April 1799 -

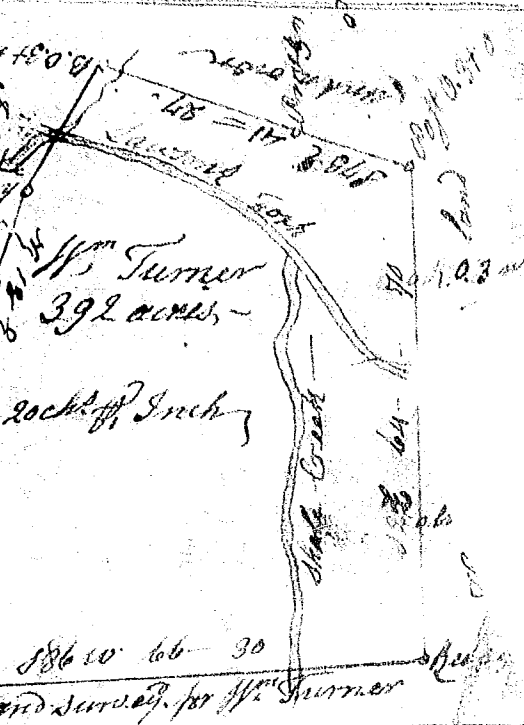

South Carolina Pursuant to a warrant from John Thomas, Comr of Land & Survey dated 3rd May 1799, I have admeasured and laid out unto William Turner's tract of Three hundred and ninety two acres of land in Pinkney District, Spartanburgh County on Lawson's fork of Pacolat, bounded by lines running S E by said Survey for Thomas Wood & land unknown, N E & N W by John Golightly's land, S W by land survey for William Turner, and hath such form and marks as the above Plat represents Survey 3rd May 1799 - Galt Benson D.S.
Recorded 4th May 1799 -



South Carolina Pursuant to a warrant from John Thomas, Comr of Land & Survey dated 10th Decr 1798, I have admeasured and laid out unto Garby Turner's tract of twenty six acres of land in Pinkney District, Spartanburgh County near Lawson's fork of Pacolat, bounded by lines S E by John Bennet, N E Thomas Wood's land, N W by William Wood's land, and hath such shape & marks as the above Plat represents Survey 28th Decr 1798, Galt Benson D.S.
Recorded 21st May 1799 -

