

South Carolina Pursuant to a warrant from John Thomas Esq
 of look & side Saluda. dated 1st feby. 1799. I have admeasured
 - admeasured and laid out unto Solomon Littlefield a tract of
 thirty acres of land, in Pickney District Spar
 County on the S. side of Tyger river on a small branch
 of Turney's Creek, a branch of Tyger river, bounded
 N. by Francis Beard's land S. by an old line owned by
 known N. by John & Henry's land N.E. by Alexr
 Dunlapp's land and hath shape & marks
 as the above plat represents. Survey 12 feby. 1799
 Recorded 14th March 1799

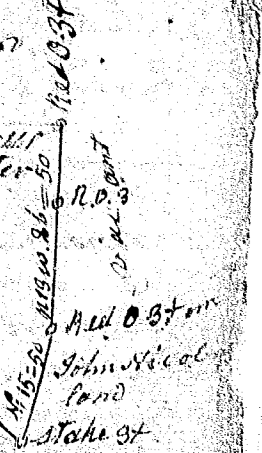

State of South Carolina Pursuant to a warrant
 from John Thomas Esq of look dated 6th March
 1798. I have admeasured and laid out unto
 John Forester a tract of 96 acres of land in
 Greenville County on both sides of
 the branches of Wines Creek of the
 - river waters of Saluda bounded
 E by land laid out for John Small S.W. by
 land laid out for Trammel, all other sides
 vacant, and hath such shape and marks
 as the above plat represents. Survey 6th March 1798.
 Recorded 22 March 1798 - George Salmon Esq



South Carolina Pursuant to a warrant
 of. dated 30th March 1799, I have admeasured
 - admeasured & laid out unto Thomas
 B. Hunt a tract of 273 acres of
 land in Union County N. side
 of Tyger river on small branches
 of Butchmans Creek, bounded N.
 by & north N. by said Hunt's land
 13.4 by gent. Brandons land 8.7
 & north 7.7 by Stephen Laytons land
 20.4 by 2.7 by Archibald Howards
 land N.E. & E. 7 by John Ingrams land
 and John Mc pharsons land, all other
 sides by vacant land, and hath such
 shape and marks as the annexed plat
 represents. Survey 1st April 1799
 Recorded 11th April 1799
 Lewis Lancaster Esq

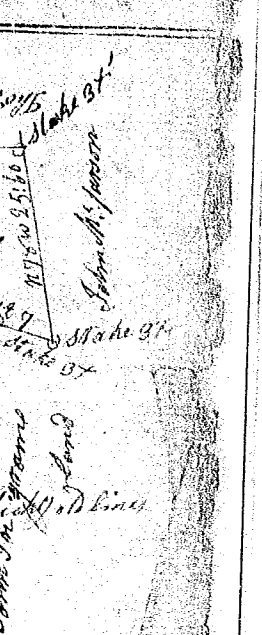

Pursuant to a warrant of. I have admeasured and
 laid out unto Thomas B. Hunt a tract of 273 acres
 land in Union County on the N. side of Tyger river
 on small branches of B. Butchmans Creek of said river bounded
 - ded 1st 8.7 by George Wankling land, 20.4 by John B. Smith
 5.7 by John Mc pharson and hath such shape & marks as
 the above plat represents. Survey 1st March 1799
 Recorded 4 April 1799
 Lewis Lancaster Esq

