

South Carolina. Pickens District
 Pursuant to a warrant from
 John Thomas Esq. Esq. dated the
 22nd of 1798, I have admeasured
 a tract of land containing sixty three
 acres in Union County on the north
 side of Sugar River, bounded to the
 north by said river to the west by P. John H. Gresham's land
 to the east by Andrew George's land & to the south the
 above plat represents. Surveyed the 24th day of Nov. 1798
 Recorded in 18th of Feb. 1799 Andrew Thomson D.

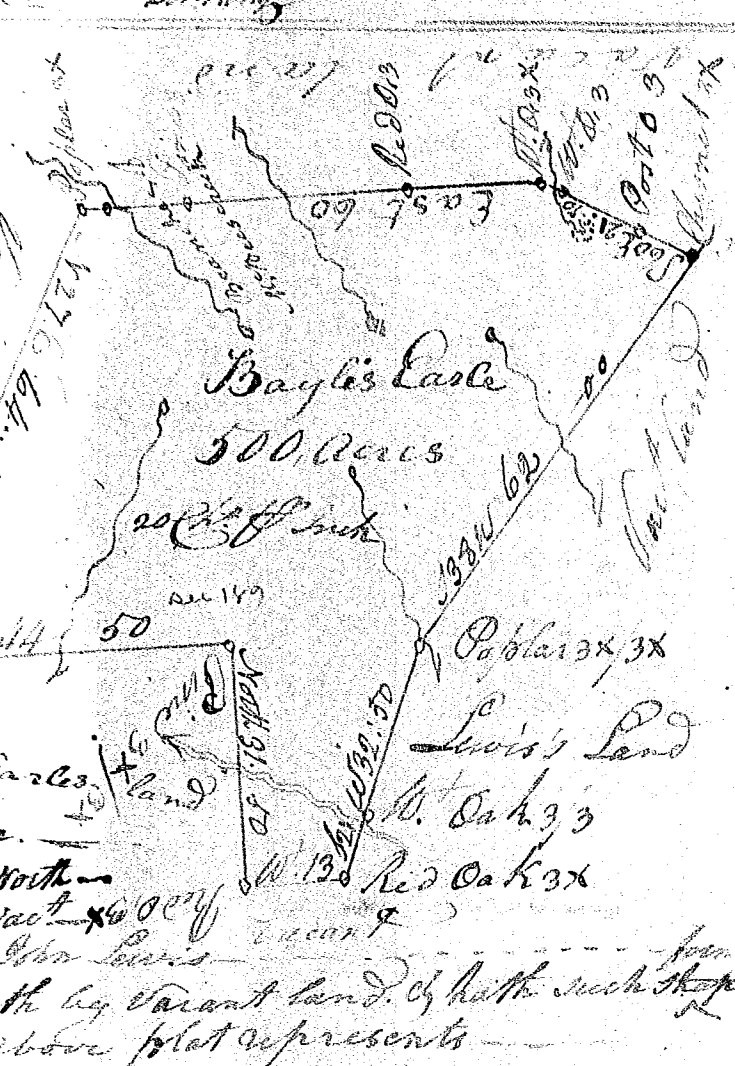

South Carolina
 Pursuant to a
 Warrant from John
 Thomas Esq. Common
 Location dated the
 17th March 1797. I have
 admeasured & laid
 out unto Baylis
 Earle Sen. a tract
 of Five Hundred
 acres of land,
 Situate in Pickens
 District, Hartland
 &burgh locality
 On both sides of
 Millcreek & the
 branches of Mill
 Creek, the waters
 of North Pacolet
 River.
 Bounded to the SE by North
 by said Earle's land by east
 land, to the SW by John Lewis
 vacant, to the south by vacant land. of both such the
 and marks as the above plat represents



Surveyed the 21st day of March 1797
 Recorded 19th February 1799
 John Young Junr.