

South Carolina Pursuant to agreement from John  
 Thomas son of John & Sara Saluda dated 8<sup>th</sup> Dec  
 1798. I have advertised and laid out unto  
 John Miller a tract of thirty two acres of  
 land, in both sides of Saffers branch of Thomas  
 Creek of parolet river in Spartanburg County  
 Bounding by a line running N.W. by land  
 granted to Thomas Carter, S.E. by Robert Cropper  
 N.E. by Col. Jellies land, and both such shapes and  
 marks as the above  
 plat represents, Survey 14<sup>th</sup> Dec 1798.  
 Recorded 1<sup>st</sup> Jan<sup>y</sup> 1799.

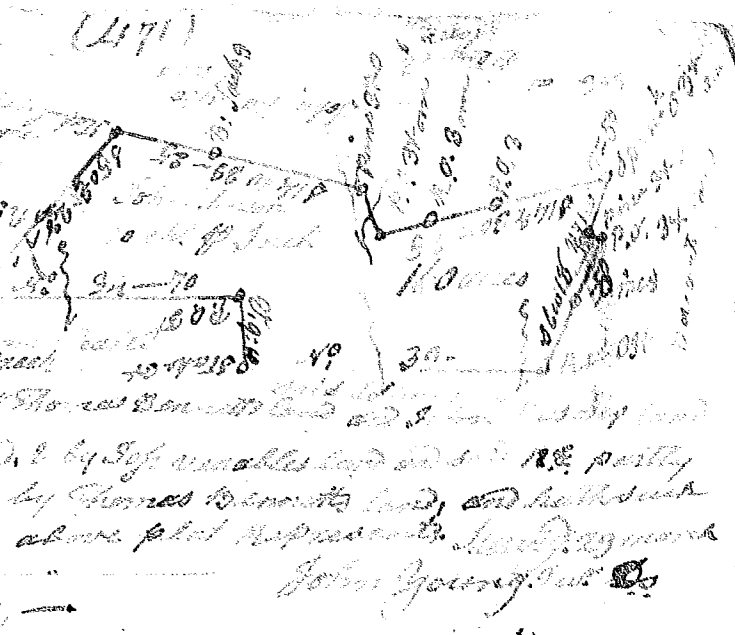

South Carolina Pursuant to agreement from John  
 Thomas son of John & Sara Saluda dated 8<sup>th</sup> Dec  
 1798. I have advertised and laid out unto  
 John Miller a tract of thirty two acres of  
 land, in both sides of Saffers branch of Thomas  
 Creek of parolet river in Spartanburg County  
 Bounding by a line running N.W. by land  
 granted to Thomas Carter, S.E. by Robert Cropper  
 N.E. by Col. Jellies land, and both such shapes and  
 marks as the above  
 plat represents, Survey 14<sup>th</sup> Dec 1798.  
 Recorded 2<sup>nd</sup> Jan<sup>y</sup> 1799.

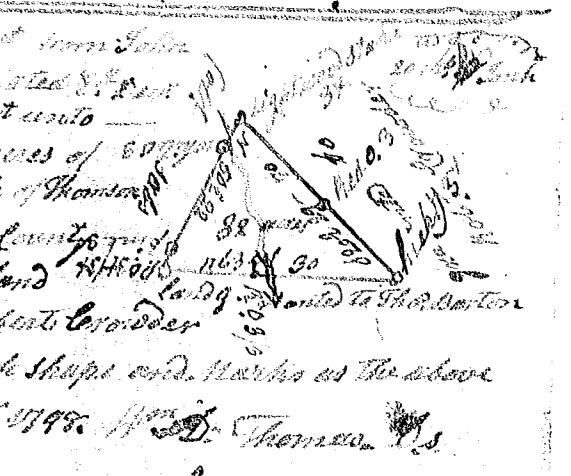

State of South Carolina Pursuant to agreement from  
 John Thomas son of John & Sara Saluda, dated  
 18<sup>th</sup> Dec 1798. I have advertised and laid  
 out unto John Miller a tract of fifty eight  
 acres of land, in Spartanburg County  
 near the N side of Tiger river bound  
 towards S.E. by Jeremiah Silmans  
 and David Leachs Lands, S.W. by  
 the said John Miller & William  
 Hofters lands N.W. by an old line owners  
 and both such shapes and marks as the above  
 plat represents. Survey 28<sup>th</sup> Dec 1798.  
 Recorded 3<sup>rd</sup> January 1799.

