

State of Carolina Pursuant to a warrant from John Thomas, Comr. of locations, N. side Saluda, dated 19<sup>th</sup> Sept. 1798, I have admeasured and laid out unto John Moore, a tract of seventy six acres of land in Greenville County, on both sides of Beatty's fork Branch of the upper of Middle fork of Saluda River bounded SW. by John Oliver's land, all other sides vacant land and hath such shape and marks as the above plot represents, Survey. 20<sup>th</sup> Dec. 1798

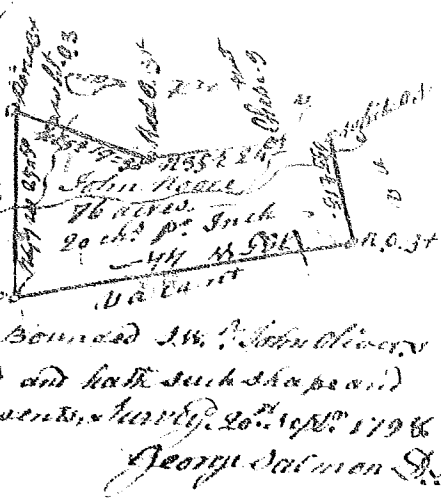

George Salmon D.

State of Carolina  
Greenville County  
Pursuant to a warrant from John Thomas, Comr. of locations N. side Saluda dated 4<sup>th</sup> Dec. 1798 I have admeasured and laid out unto Henry Matchins a tract of four hundred & seventy nine acres of land lying on the north side of Branch Creek of Meedy river bounded N.W. by Absters land N.E. by land Henry unknown S.E. by vacant land S.W. & S. by Daniel Flanery's land SW. by Absters land, and hath such shape and marks as the above plot represents, Survey. 6<sup>th</sup> Dec. 1798

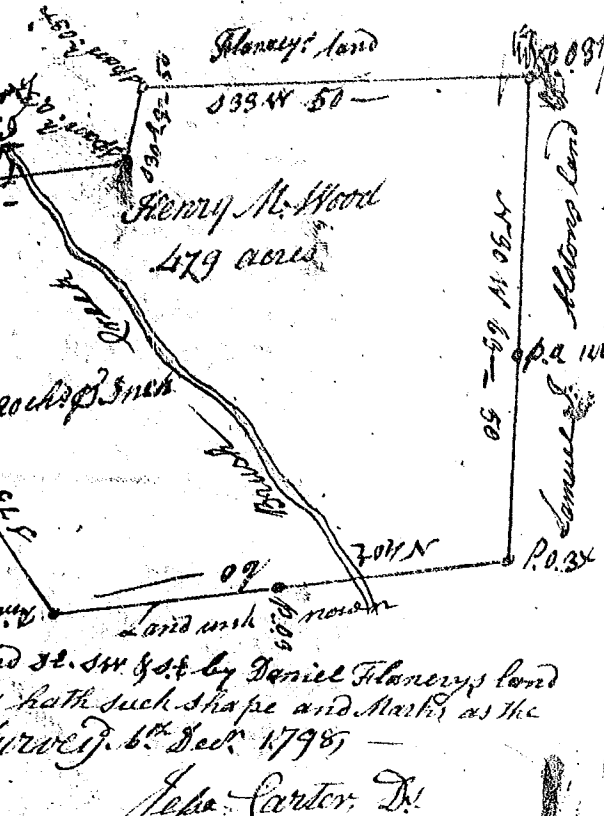

John Carter D.

State of Carolina  
Pursuant to a warrant from John Thomas, Comr. of locations N. side Saluda, dated the 20<sup>th</sup> Oct. 1798, I have admeasured and laid out unto William Morris a tract of 39 acres of land, lying in the County of Hartman or South side of Gocher creek of Michetty run of Broad River near the old Ferry Tail bounded on the N.E. by said Morris's land West by Absters land South by land of Lipscomb & others & hath such marks, boundaries & boundaries as the above plot represents

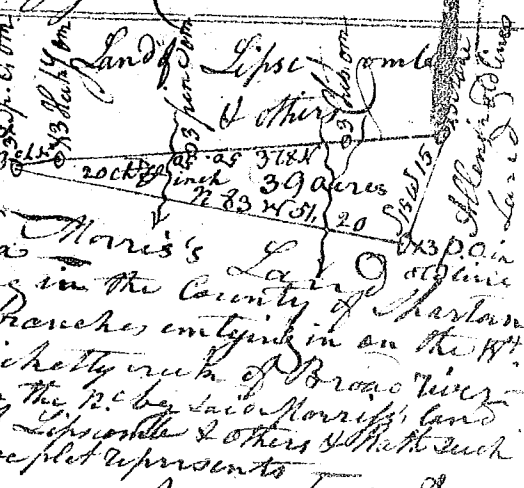

Recorded the 22<sup>nd</sup> Oct. 1798 James Smith D.