

South Carolina Pursuant to
 warrant from John Thomas
 Comr of loc^y north side saluda
 dated 9th april 1798 I have
 admeasured and laid out unto
 Absolom Thomson a tract of seventy
 one acres of land, on a small branch
 of the pinch hole fork of middle Tyger
 River in greenville County bounded by elina passing &c. by John
 Gowins Land, by eline N^o, by land laid out, & by George Lewis
 Land, West by Absolom Thomson's Land and hath such form & marks as
 the above plat represents Survey 14th april 1798. W^m J. Farman
 Recorded 21st Nov^r 1798

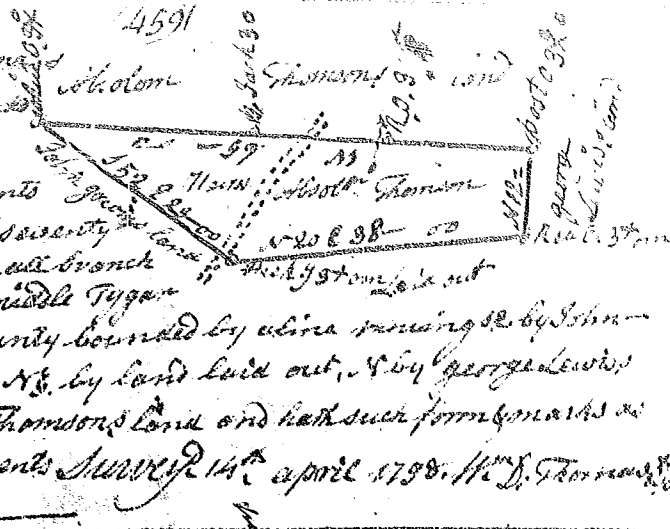

South Carolina Pursuant to
 warrant from John Thomas
 Comr of loc^y N side saluda
 dated 31st Oct^r 1798 I have
 admeasured and laid out
 unto Capt. James Kugel a
 tract of 56 acres of Land in
 Laurens County, on both sides
 of Durbin's Creek waters of
 Enoree river, bounded by lines
 running SW & SE by James
 Gilbert Sr & N^o by John Deans Land
 James Kessells own Land &
 anicajah Hugh's Land NW by
 Joseph Bartons Land, and hath
 such shape and marks as the
 above plat represents Survey
 31st Oct^r 1798
 Recorded 21st Nov^r 1798
 James Kelgore Sr

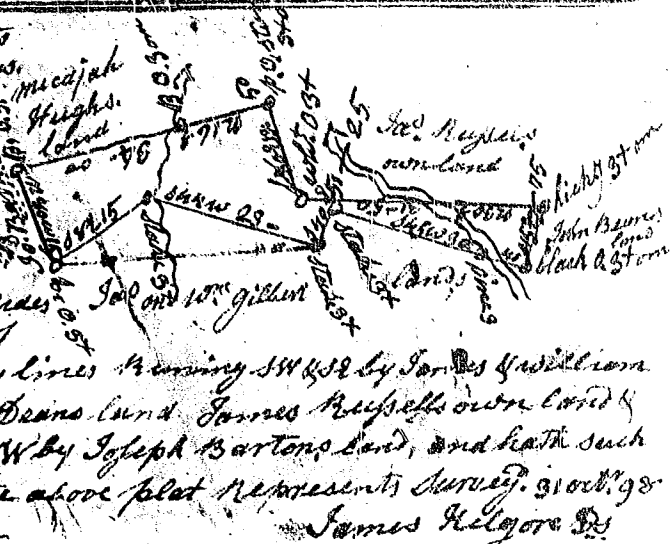

South Carolina Pursuant to
 warrant from John Thomas Comr
 of loc^y N. side saluda dated 5th
 Dec^r 1798, I have admeasured
 and laid out unto Thomas
 Mungey a tract of 39 acres of
 land in Washington District,
 greenville County, on both
 sides of a small branch of the
 Grove Creek waters of saluda
 bounded N. by Robt. Maxwells
 land N. by Bowies land SE by
 Richard goods land S by
 Ambrose Blackburs Land and
 hath such shape and marks as
 the above plat represents
 Survey 4th Dec^r 1798 John Young
 Sur^r Recorded 29th Dec^r 1798

